

TERRACE

NINTH FLOOR

EIGHT FLOOR

SEVENTH FLOOR

SIXTH FLOOR

FIFTH FLOOR

FOURTH FLOOR

CONCOURSE FLOOR

SECOND FLOOR

FIRST FLOOR

GROUND FLOOR

BASEMENT

- NOTES:
1. ALL DIMENSIONS AND LEVELS ARE IN M, UNLESS OTHERWISE MENTIONED.
  2. DRAWINGS SHALL NOT BE SCALED. ONLY WRITTEN DIMENSIONS SHALL BE FOLLOWED.
  3. NO WORK SHALL START WITHOUT APPROVED GOOD FOR CONSTRUCTION DRAWING.
  4. THIS IS THE CONCEPTUAL DRAWING AND DETAILED ENGINEERING DESIGN SHALL BE THE RESPONSIBILITY OF EXECUTING IMPLEMENTING AGENCIES.
  5. ACQUISITION OF LAND FOR IMPLEMENTATION OF PROJECT SHALL BE THE RESPONSIBILITY OF EXECUTING IMPLEMENTING AGENCIES.
  6. ALL REQUIRED STATUTORY CLEARANCES ARE TO BE OBTAINED BY THE EXECUTING IMPLEMENTING AGENCIES.
  7. THE NECESSARY PERMISSION FOR CUTTING OF TREES SHALL BE OBTAINED BY THE EXECUTING IMPLEMENTING AGENCIES FROM CONCERNED DEPT AS PER THE EXISTING POLICY.

REMARKS:

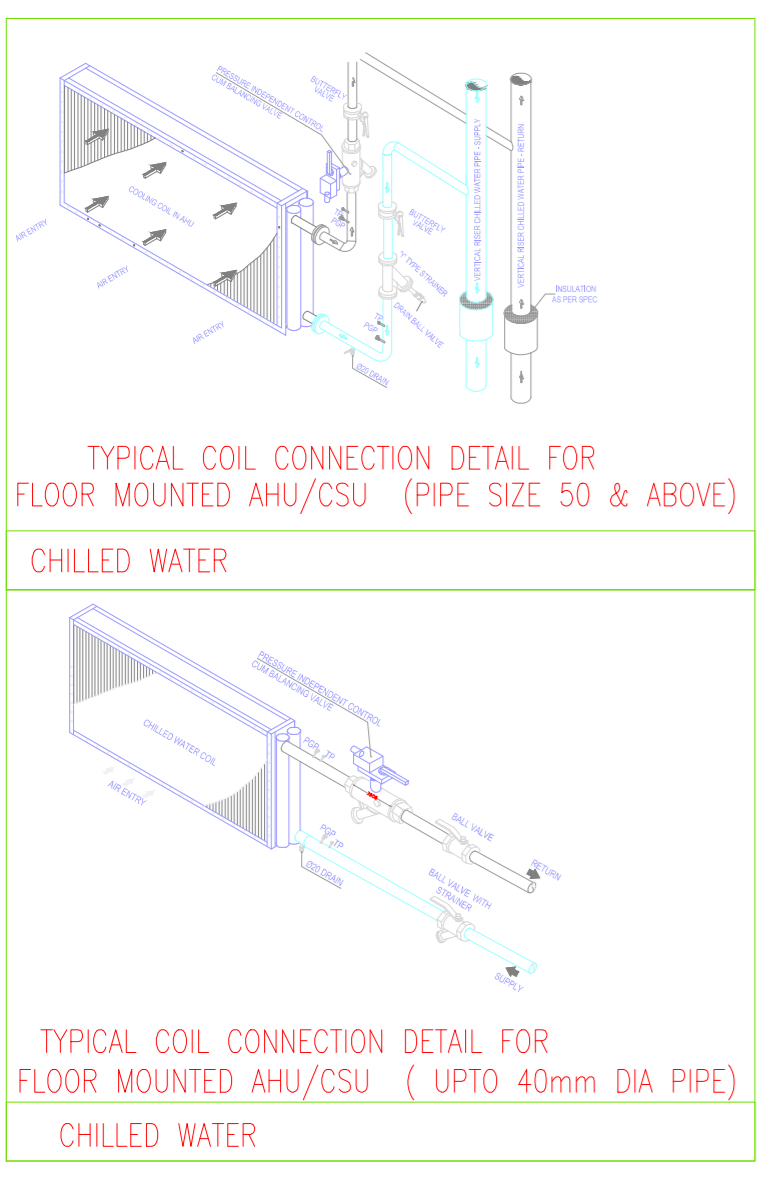

**LEGEND :-**

NAMES	SYMBOL
MOTORIZED BUTTERFLY VALVE	
BUTTERFLY VALVE	
NON RETURN VALVE	
BALANCING VALVE	
"Y" STRAINER	
PRESSURE GAUGE	
THERMOMETER	
FLOW SWITCH	
POT STRAINER	
AIR SEPARATOR	
EXPANSION TANK	
FLEXIBLE CONNECTION	
PUMP	
CHILLED WATER SUPPLY	
CHILLED WATER RETURN	

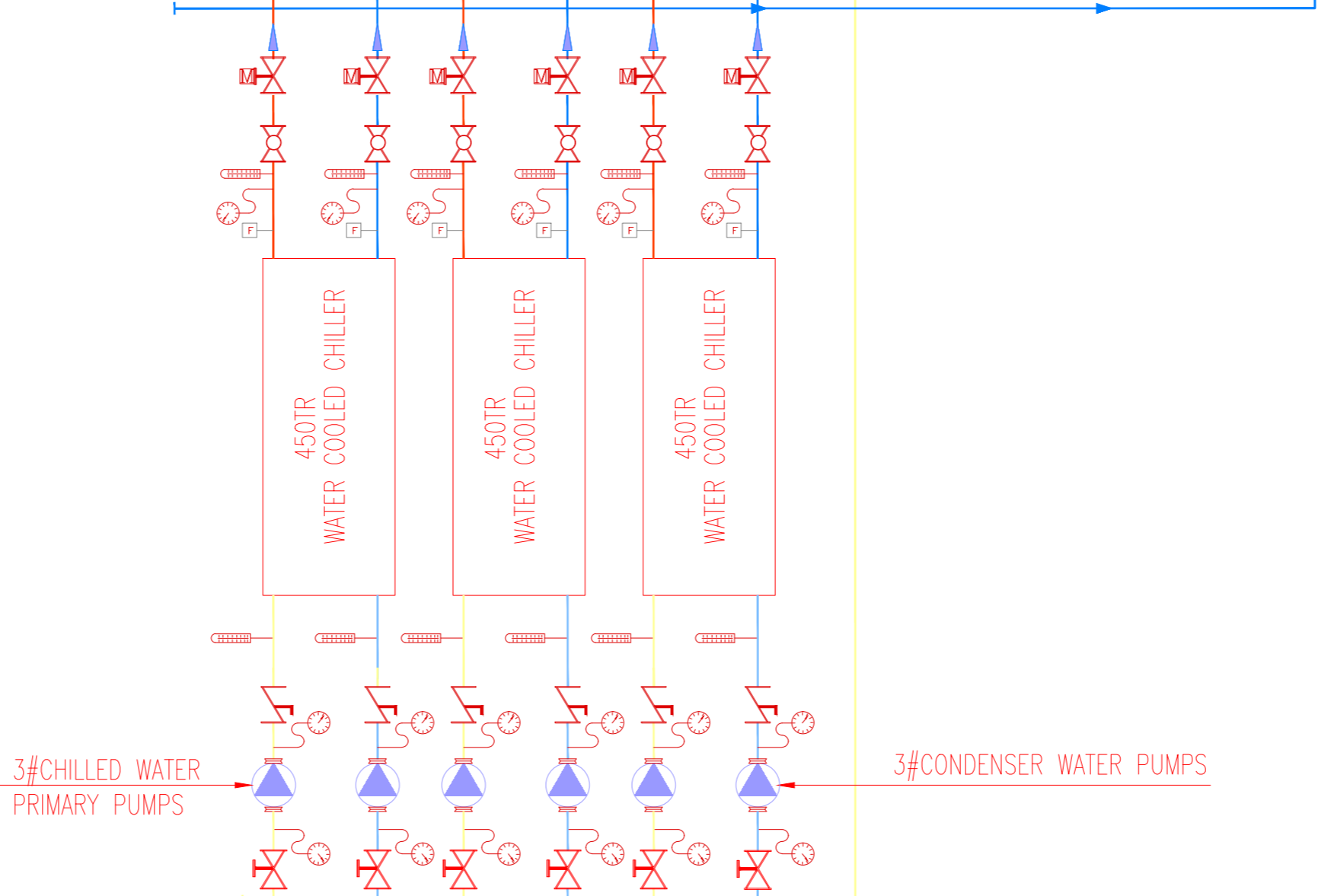

PROJECT : MUMBAI - AHMEDABAD HIGH SPEED RAIL PROJECT

OWNER : NHSRCL, Asa Bhatwari, 2nd Floor, Sector 9, Dwarka, Delhi - 110077

CONSULTANT : RITES THE INFRASTRUCTURE PEOPLE

RITES Bhawan, Plot No.1, Sector 29, Gurugram - 122001

ARCHITECTS: DESIGN WORKSHOP

100B - C Block, Kalkaji, New Delhi - 110019

STAGE II SUBMISSION

APPROVED BY: NHSRCL

PREPARED BY: RITES LTD.

SIGNATURE (ARCHITECT) DATE: SIGNATURE (ENGINEER) DATE: SIGNATURE (SM CIVIL) DATE:

TITLE: **SABARMATI HSR TERMINAL**

DWG TITLE: HVAC SCHEMATIC DIAGRAM

DWG NO.: HSR/SABARMATI/HVAC-01

SCALE: NTS

REVISION: R0

DATE: 15.06.2018

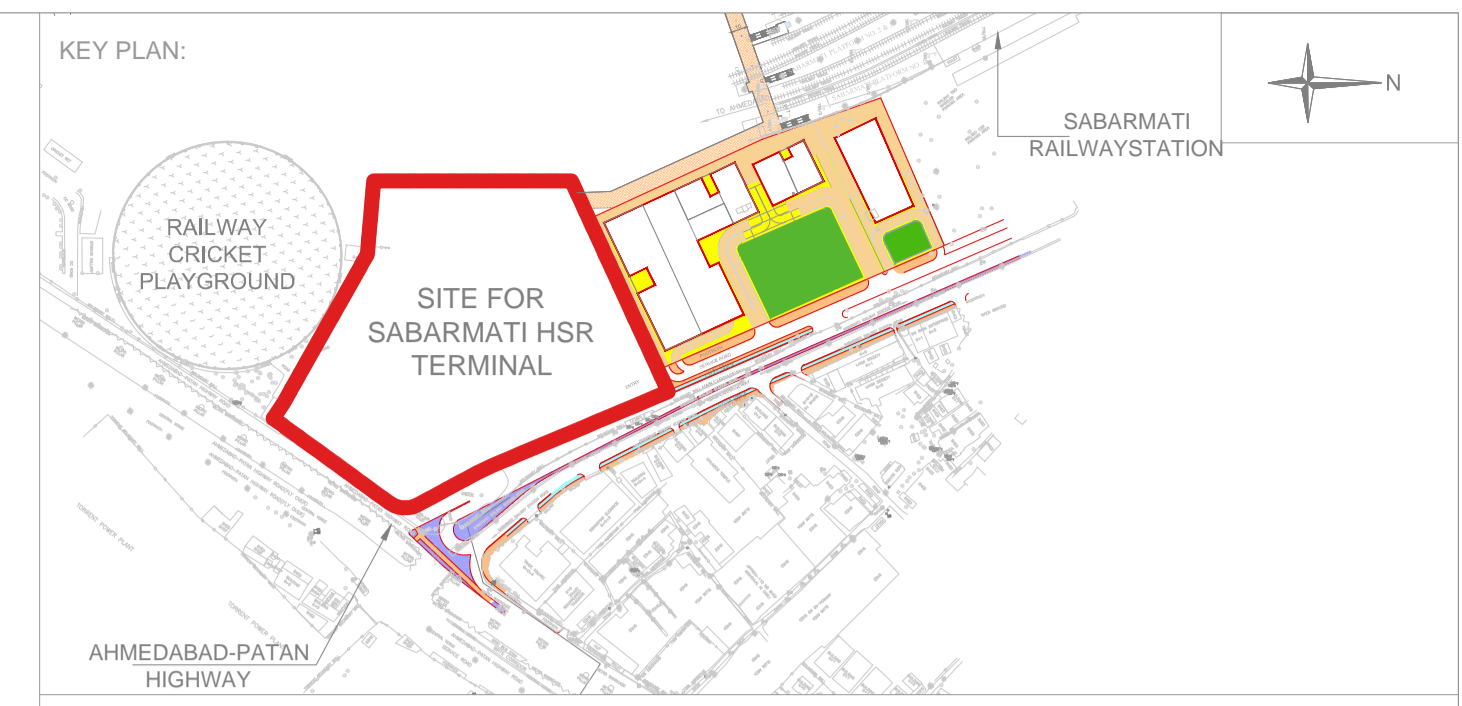
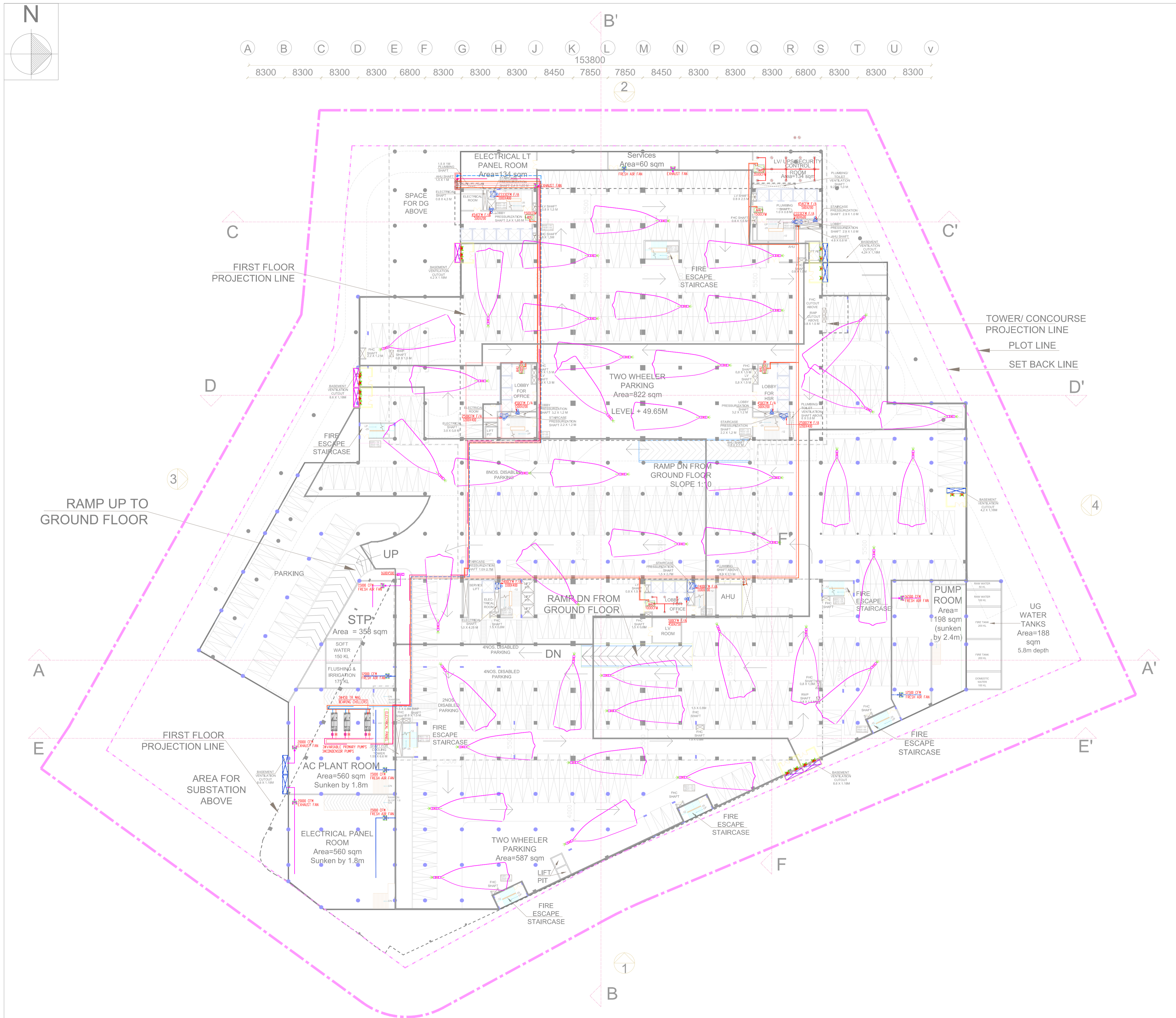

- NOTES:**
1. ALL DIMENSIONS AND LEVELS ARE IN M., UNLESS OTHERWISE MENTIONED.
  2. DRAWING SHALL NOT BE SCALED; ONLY WRITTEN DIMENSIONS SHALL BE FOLLOWED.
  3. NO WORK SHALL START WITHOUT APPROVED GOOD-FOR-CONSTRUCTION DRAWING.
  4. THIS IS THE CONCEPTUAL DRAWING AND DETAILED ENGINEERING DESIGN SHALL BE THE RESPONSIBILITY OF EXECUTING/ IMPLEMENTING AGENCIES.
  5. ACQUISITION OF LAND FOR IMPLEMENTATION OF PROJECT SHALL BE THE RESPONSIBILITY OF EXECUTING/ IMPLEMENTING AGENCIES.
  6. ALL REQUIRED STATUTORY CLEARANCES ARE TO BE OBTAINED BY THE EXECUTING/ IMPLEMENTING AGENCIES.
  7. THE NECESSARY PERMISSION FOR CUTTING OF TREES SHALL BE OBTAINED BY THE EXECUTING/ IMPLEMENTING AGENCIES FROM CONCERNED DEPT. AS PER THE EXISTING POLICY.

**REMARKS:**

LEGEND		
S.NO	SYMBOL	DESCRIPTION
1.		SUPPLY AIR DIFF.
2.		RETURN AIR DIFF.
3.		SUPPLY AIR DUCT
4.		FRESH AIR SUPPLY DUCT
5.		EXHAUST AIR RETURN DUCT
6.		CHILLED WATER SUPPLY
7.		CHILLED WATER SUPPLY
8.		CONDENSER WATER SUPPLY
9.		CONDENSER WATER RETURN
10.		MOTORIZED DAMPER

**STAGE II SUBMISSION**

APPROVED BY: NHSRCL

---

SIGNATURE: (Chief Architect)      DATE:      SIGNATURE: (ED/Planning)      DATE:

PREPARED BY: RITES LTD.

---

SIGNATURE: (ARCHITECT)      DATE:      SIGNATURE: (MGR/CIVIL)      DATE:      SIGNATURE: (GM/ CIVIL)      DATE:

TITLE:

**SABARMATI HSR TERMINAL**

DWG TITLE: **BASEMENT LEVEL - HVAC LAYOUT**

DWG NO: HSR/SABARMATI/HVAC-02

SCALE: **1:350**

REVISION: R0

DATE: 15.06.2018

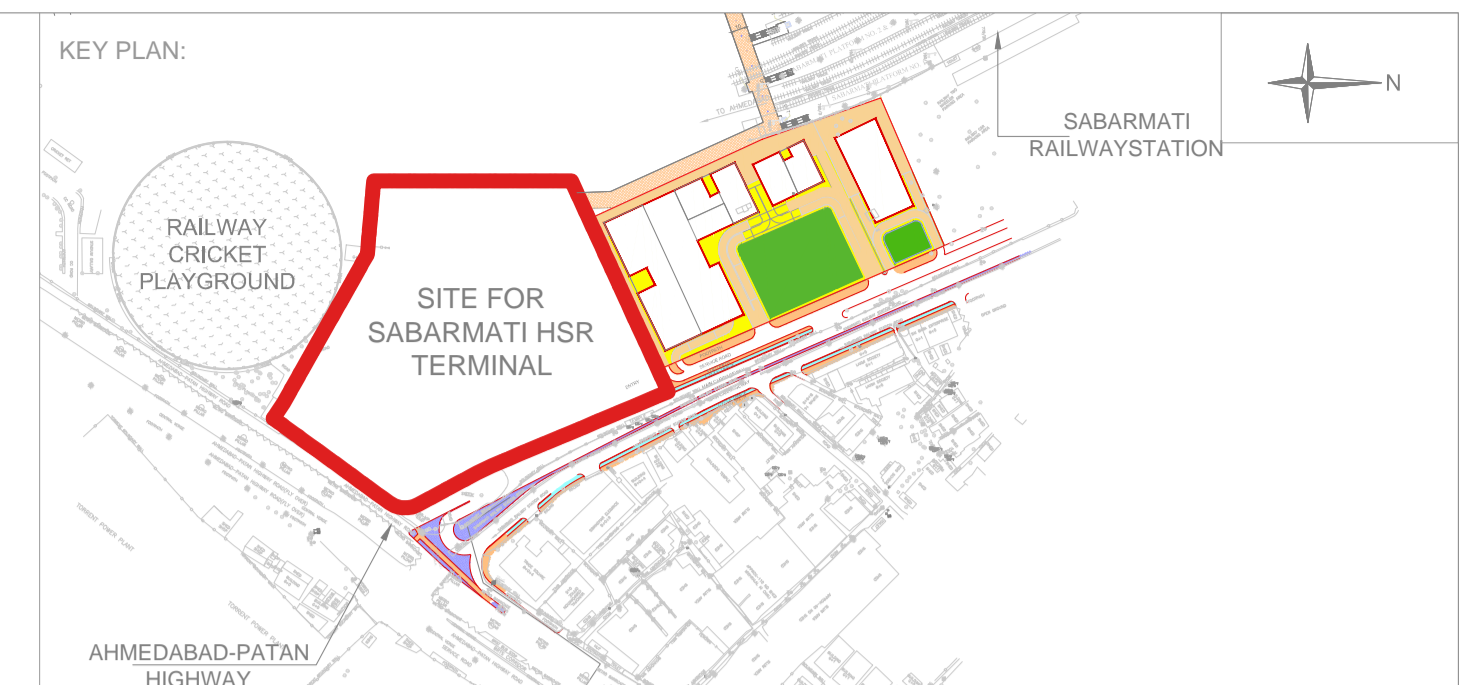
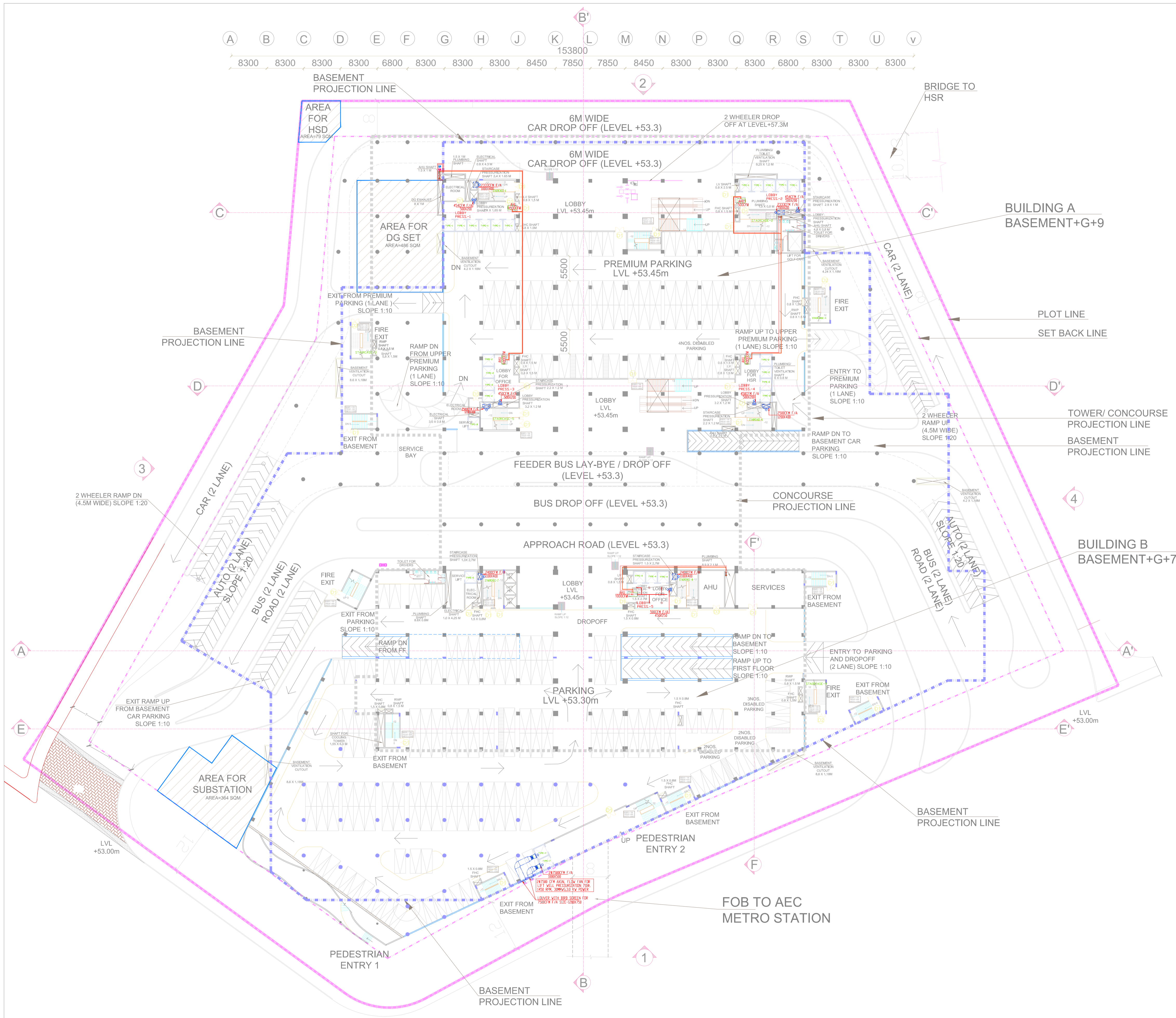

- NOTES:**
1. ALL DIMENSIONS AND LEVELS ARE IN M., UNLESS OTHERWISE MENTIONED.
  2. DRAWING SHALL NOT BE SCALED; ONLY WRITTEN DIMENSIONS SHALL BE FOLLOWED.
  3. NO WORK SHALL START WITHOUT APPROVED GOOD-FOR-CONSTRUCTION DRAWING.
  4. THIS IS THE CONCEPTUAL DRAWING AND DETAILED ENGINEERING DESIGN SHALL BE THE RESPONSIBILITY OF EXECUTING/ IMPLEMENTING AGENCIES.
  5. ACQUISITION OF LAND FOR IMPLEMENTATION OF PROJECT SHALL BE THE RESPONSIBILITY OF EXECUTING/ IMPLEMENTING AGENCIES.
  6. ALL REQUIRED STATUTORY CLEARANCES ARE TO BE OBTAINED BY THE EXECUTING/ IMPLEMENTING AGENCIES.
  7. THE NECESSARY PERMISSION FOR CUTTING OF TREES SHALL BE OBTAINED BY THE EXECUTING/ IMPLEMENTING AGENCIES FROM CONCERNED DEPT. AS PER THE EXISTING POLICY.

**REMARKS:**

LEGEND		
S.NO	SYMBOL	DESCRIPTION
1.		SUPPLY AIR DIFF.
2.		RETURN AIR DIFF.
3.		SUPPLY AIR DUCT
4.		FRESH AIR SUPPLY DUCT
5.		EXHAUST AIR RETURN DUCT
6.		CHILLED WATER SUPPLY
7.		CHILLED WATER SUPPLY
8.		CONDENSER WATER SUPPLY
9.		CONDENSER WATER RETURN
10.		MOTORIZED DAMPER

STAGE II SUBMISSION

APPROVED BY:		NHSRCL	
SIGNATURE: (Chief Architect)	DATE:	SIGNATURE: (ED/Planning)	DATE:
PREPARED BY: RITES LTD.			
SIGNATURE: (ARCHITECT)	DATE:	SIGNATURE: (MGR/CIVIL)	DATE:
SIGNATURE: (GM/ CIVIL)	DATE:	SIGNATURE: (GM/ CIVIL)	DATE:
TITLE:			

**SABARMATI HSR TERMINAL**

DWG TITLE:	GROUND FLOOR HVAC LAYOUT
DWG NO:	HSR/SABARMATI/HVAC-03
SCALE:	1:350
REVISION: R0	DATE: 15.06.2018

PROJECT: MUMBAI - AHMEDABAD HIGH SPEED RAIL PROJECT

OWNER: NHSRCL, Asia Bhawan, 2nd Floor, Sector 9, Dwarka, Delhi - 110077

CONSULTANT: RITES Bhawan, Plot No.1, Sector 29, Gurugram - 122001

ARCHITECTS: DESIGN WORKSHOP, 100B - C Block, Kalkaji, New Delhi - 110019

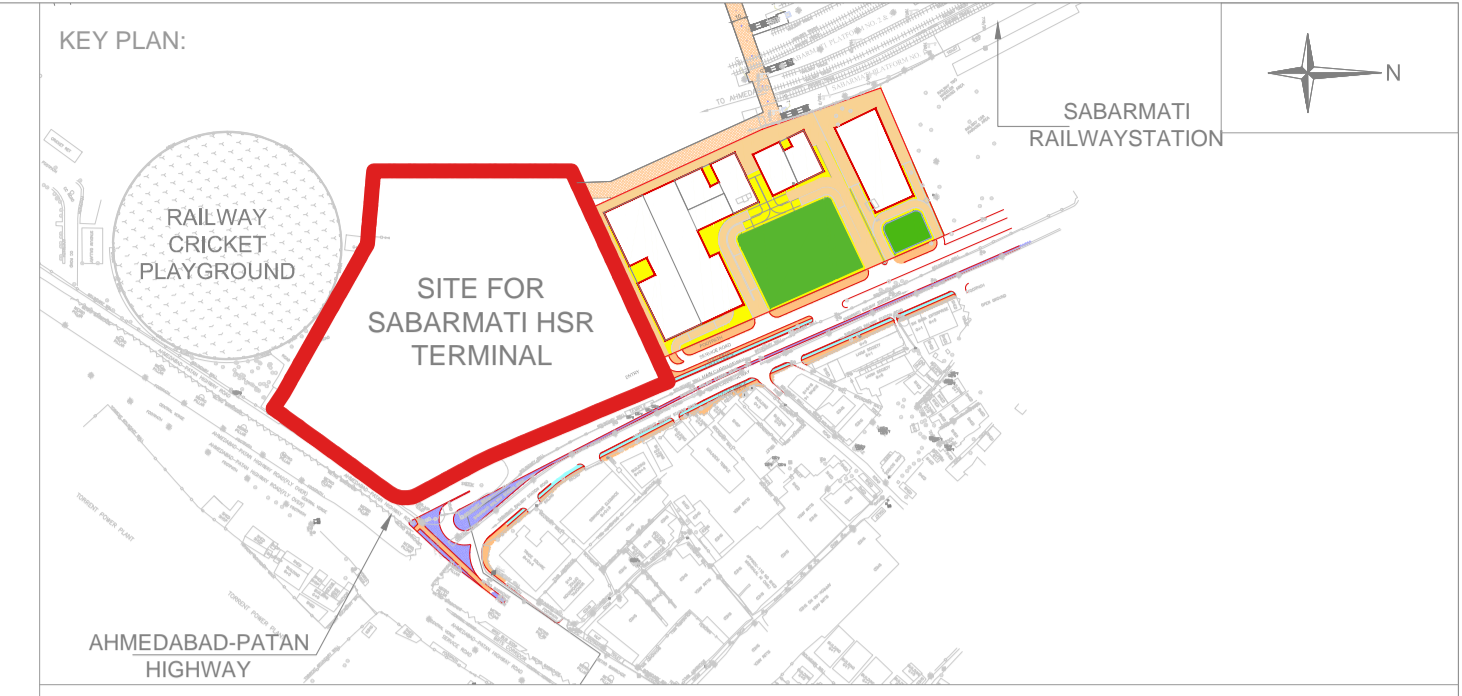
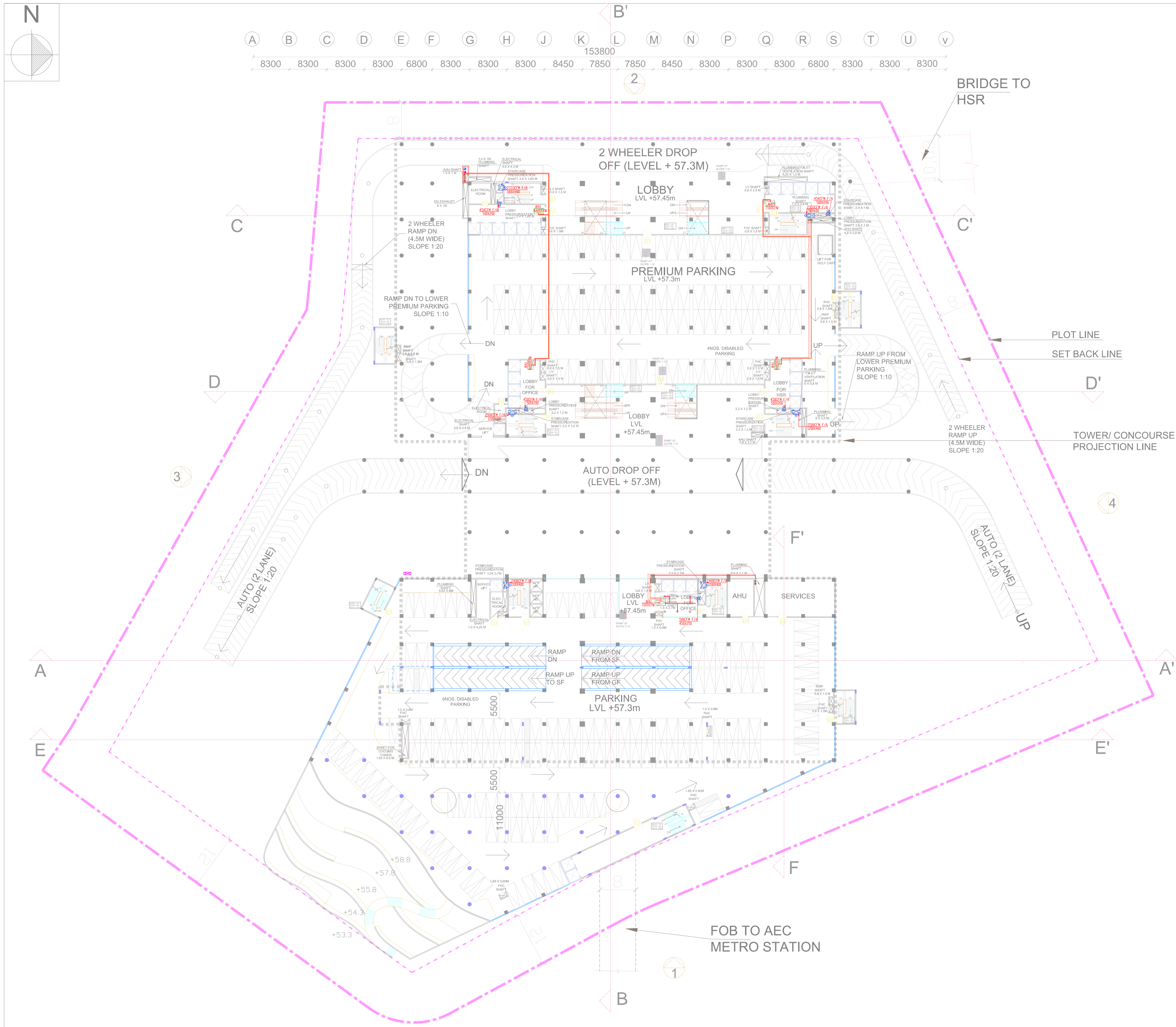

- NOTES:
1. ALL DIMENSIONS AND LEVELS ARE IN M., UNLESS OTHERWISE MENTIONED.
  2. DRAWING SHALL NOT BE SCALED; ONLY WRITTEN DIMENSIONS SHALL BE FOLLOWED.
  3. NO WORK SHALL START WITHOUT APPROVED GOOD-FOR-CONSTRUCTION DRAWING.
  4. THIS IS THE CONCEPTUAL DRAWING AND DETAILED ENGINEERING DESIGN SHALL BE THE RESPONSIBILITY OF EXECUTING/ IMPLEMENTING AGENCIES.
  5. ACQUISITION OF LAND FOR IMPLEMENTATION OF PROJECT SHALL BE THE RESPONSIBILITY OF EXECUTING/ IMPLEMENTING AGENCIES.
  6. ALL REQUIRED STATUTORY CLEARANCES ARE TO BE OBTAINED BY THE EXECUTING/ IMPLEMENTING AGENCIES.
  7. THE NECESSARY PERMISSION FOR CUTTING OF TREES SHALL BE OBTAINED BY THE EXECUTING/ IMPLEMENTING AGENCIES FROM CONCERNED DEPT. AS PER THE EXISTING POLICY.

REMARKS:

LEGEND		
S.NO	SYMBOL	DESCRIPTION
1.		SUPPLY AIR DIFF.
2.		RETURN AIR DIFF.
3.		SUPPLY AIR DUCT
4.		FRESH AIR SUPPLY DUCT
5.		EXHAUST AIR RETURN DUCT
6.		CHILLED WATER SUPPLY
7.		CHILLED WATER SUPPLY
8.		CONDENSER WATER SUPPLY
9.		CONDENSER WATER RETURN
10.		MOTORIZED DAMPER

STAGE II SUBMISSION

APPROVED BY: NHSRCL

SIGNATURE: (Chief Architect) \_\_\_\_\_ DATE: \_\_\_\_\_ SIGNATURE: (ED/Planning) \_\_\_\_\_ DATE: \_\_\_\_\_

PREPARED BY: RITES LTD.

SIGNATURE: (ARCHITECT) \_\_\_\_\_ DATE: \_\_\_\_\_ SIGNATURE: (MGR/CIVIL) \_\_\_\_\_ DATE: \_\_\_\_\_ SIGNATURE: (GM/ CIVIL) \_\_\_\_\_ DATE: \_\_\_\_\_

TITLE: \_\_\_\_\_

**SABARMATI HSR TERMINAL**

DWG TITLE: **FIRST FLOOR HVAC LAYOUT**

DWG NO: HSR/SABARMATI/HVAC-04

SCALE: **1:350**

REVISION: R0

DATE: 15.06.2018

PROJECT: MUMBAI - AHMEDABAD HIGH SPEED RAIL PROJECT

OWNER: NHSRCL, Asia Bhawan, 2nd Floor, Sector 9, Dwarka, Delhi - 110077

CONSULTANT: RITES Bhawan, Plot No.1, Sector 29, Gurugram - 122001

ARCHITECTS: DESIGN WORKSHOP, 100B - C Block, Kalkaji, New Delhi - 110019

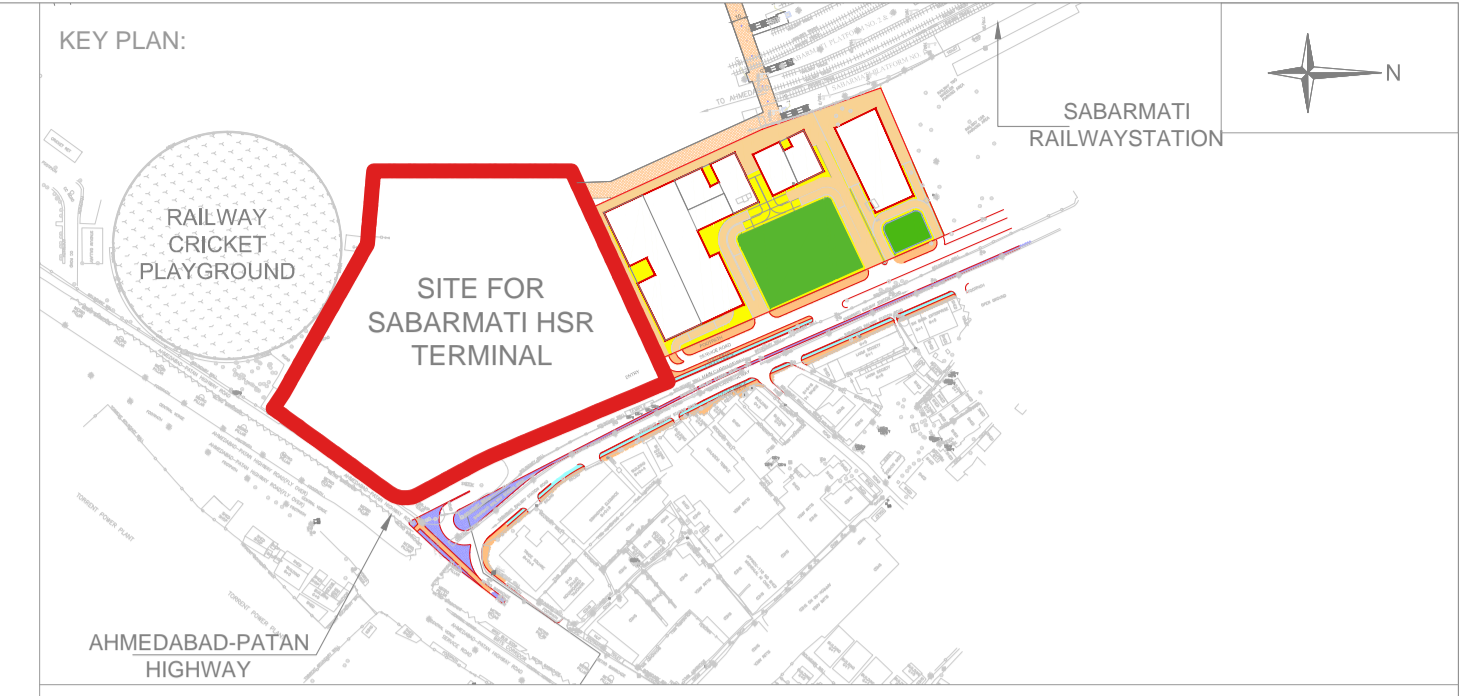
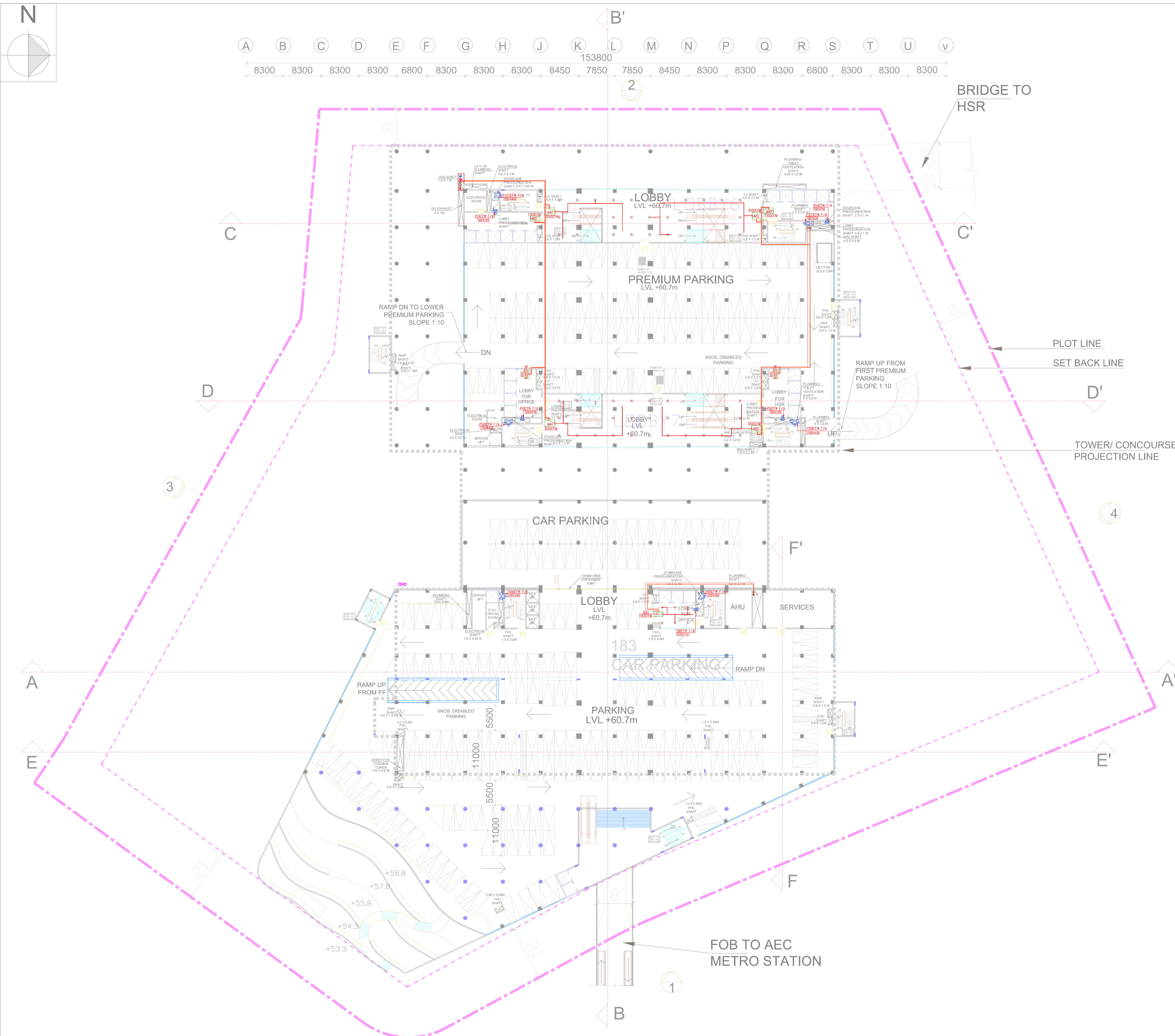

- NOTES:**
1. ALL DIMENSIONS AND LEVELS ARE IN M., UNLESS OTHERWISE MENTIONED.
  2. DRAWING SHALL NOT BE SCALED; ONLY WRITTEN DIMENSIONS SHALL BE FOLLOWED.
  3. NO WORK SHALL START WITHOUT APPROVED GOOD-FOR-CONSTRUCTION DRAWING.
  4. THIS IS THE CONCEPTUAL DRAWING AND DETAILED ENGINEERING DESIGN SHALL BE THE RESPONSIBILITY OF EXECUTING/ IMPLEMENTING AGENCIES.
  5. ACQUISITION OF LAND FOR IMPLEMENTATION OF PROJECT SHALL BE THE RESPONSIBILITY OF EXECUTING/ IMPLEMENTING AGENCIES.
  6. ALL REQUIRED STATUTORY CLEARANCES ARE TO BE OBTAINED BY THE EXECUTING/ IMPLEMENTING AGENCIES.
  7. THE NECESSARY PERMISSION FOR CUTTING OF TREES SHALL BE OBTAINED BY THE EXECUTING/ IMPLEMENTING AGENCIES FROM CONCERNED DEPT. AS PER THE EXISTING POLICY.

**REMARKS:**

LEGEND		
S.NO	SYMBOL	DESCRIPTION
1.		SUPPLY AIR DIFF.
2.		RETURN AIR DIFF.
3.		SUPPLY AIR DUCT
4.		FRESH AIR SUPPLY DUCT
5.		EXHAUST AIR RETURN DUCT
6.		CHILLED WATER SUPPLY
7.		CHILLED WATER SUPPLY
8.		CONDENSER WATER SUPPLY
9.		CONDENSER WATER RETURN
10.		MOTORIZED DAMPER

STAGE II SUBMISSION

APPROVED BY:		NHSRCL	
SIGNATURE: (Chief Architect)	DATE:	SIGNATURE: (ED/Planning)	DATE:
PREPARED BY: RITES LTD.			
SIGNATURE: (ARCHITECT)	DATE:	SIGNATURE: (MGR/CIVIL)	DATE:
SIGNATURE: (GM/ CIVIL)	DATE:	SIGNATURE: (GM/ CIVIL)	DATE:
TITLE:			

**SABARMATI HSR TERMINAL**

DWG TITLE:	SECOND FLOOR HVAC LAYOUT
DWG NO:	HSR/SABARMATI/HVAC-05
SCALE:	1:350
REVISION: R0	DATE: 15.06.2018

PROJECT: MUMBAI - AHMEDABAD HIGH SPEED RAIL PROJECT

OWNER: NHSRCL, Asia Bhawan, 2nd Floor, Sector 9, Dwarka, Delhi - 110077

CONSULTANT: RITES Bhawan, Plot No.1, Sector 29, Gurugram - 122001

ARCHITECTS: DESIGN WORKSHOP, 100B - C Block, Kalkaji, New Delhi - 110019

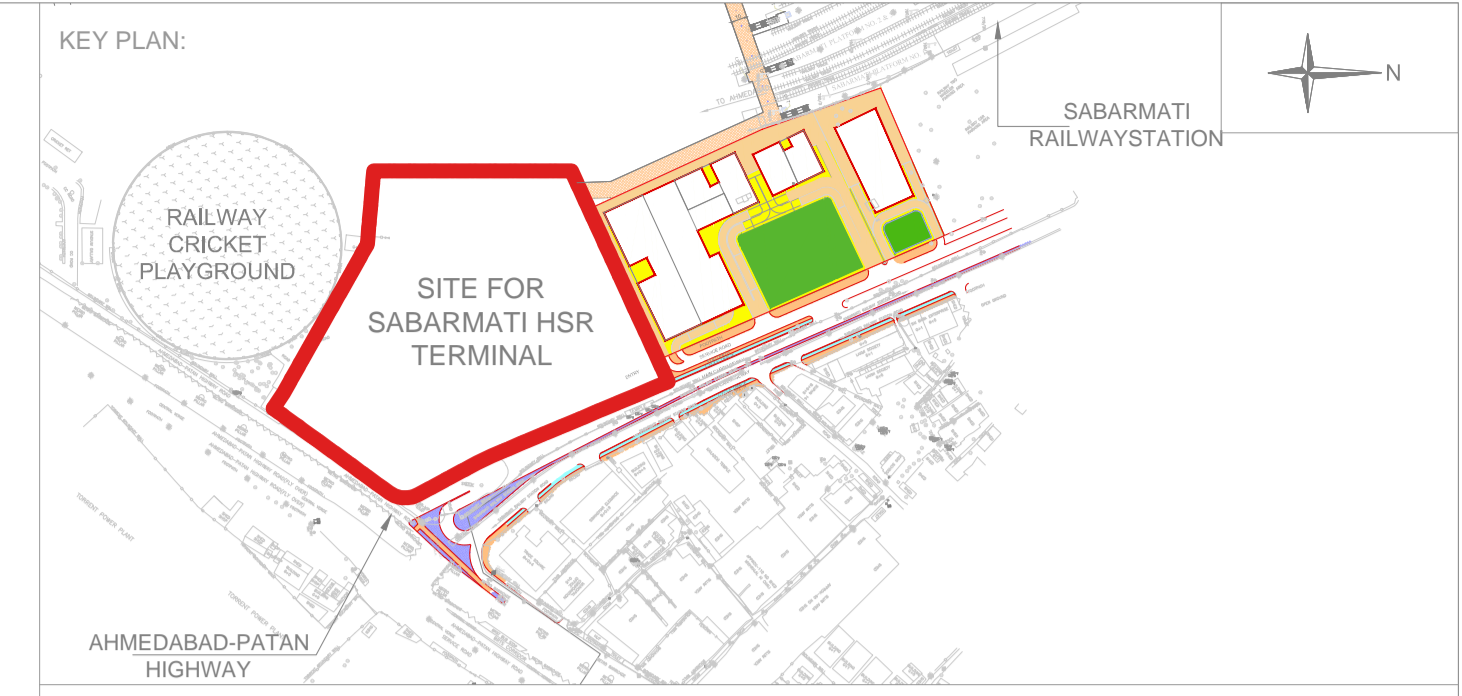
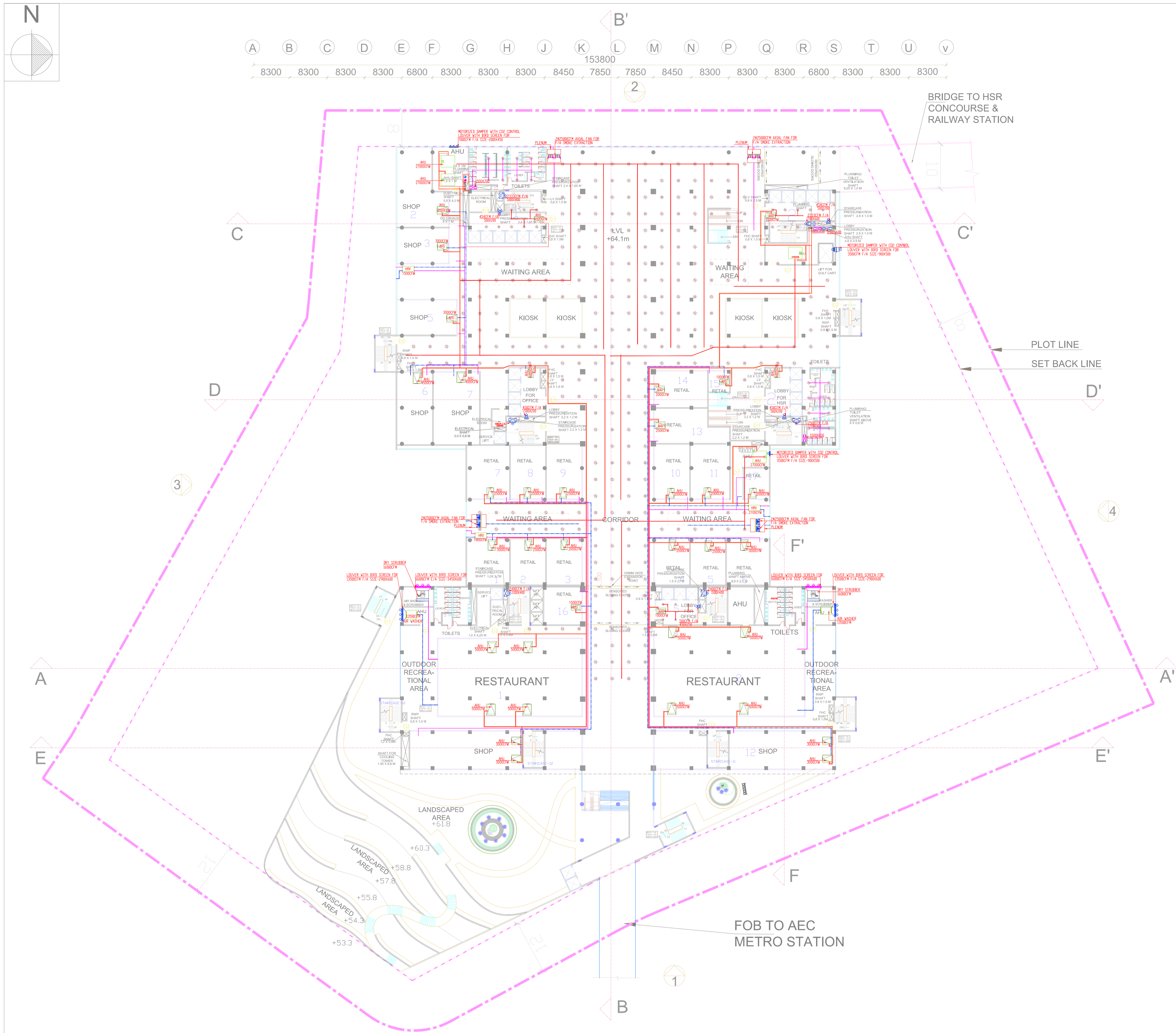

- NOTES:**
1. ALL DIMENSIONS AND LEVELS ARE IN M., UNLESS OTHERWISE MENTIONED.
  2. DRAWING SHALL NOT BE SCALED; ONLY WRITTEN DIMENSIONS SHALL BE FOLLOWED.
  3. NO WORK SHALL START WITHOUT APPROVED GOOD-FOR-CONSTRUCTION DRAWING.
  4. THIS IS THE CONCEPTUAL DRAWING AND DETAILED ENGINEERING DESIGN SHALL BE THE RESPONSIBILITY OF EXECUTING/ IMPLEMENTING AGENCIES.
  5. ACQUISITION OF LAND FOR IMPLEMENTATION OF PROJECT SHALL BE THE RESPONSIBILITY OF EXECUTING/ IMPLEMENTING AGENCIES.
  6. ALL REQUIRED STATUTORY CLEARANCES ARE TO BE OBTAINED BY THE EXECUTING/ IMPLEMENTING AGENCIES.
  7. THE NECESSARY PERMISSION FOR CUTTING OF TREES SHALL BE OBTAINED BY THE EXECUTING/ IMPLEMENTING AGENCIES FROM CONCERNED DEPT. AS PER THE EXISTING POLICY.

REMARKS:

LEGEND		
S.NO	SYMBOL	DESCRIPTION
1.		SUPPLY AIR DIFF.
2.		RETURN AIR DIFF.
3.		SUPPLY AIR DUCT
4.		FRESH AIR SUPPLY DUCT
5.		EXHAUST AIR RETURN DUCT
6.		CHILLED WATER SUPPLY
7.		CHILLED WATER SUPPLY
8.		CONDENSER WATER SUPPLY
9.		CONDENSER WATER RETURN
10.		MOTORIZED DAMPER

STAGE II SUBMISSION

APPROVED BY:		NHSRCL	
SIGNATURE: (Chief Architect)	DATE:	SIGNATURE: (ED/Planning)	DATE:
PREPARED BY: RITES LTD.			
SIGNATURE: (ARCHITECT)	DATE:	SIGNATURE: (MGR/CIVIL)	DATE:
SIGNATURE: (GM/ CIVIL)	DATE:	SIGNATURE: (GM/ CIVIL)	DATE:
TITLE:			

**SABARMATI HSR TERMINAL**

DWG TITLE:	THIRD FLOOR HVAC LAYOUT
DWG NO:	HSR/SABARMATI/HVAC-06
SCALE:	1:350
REVISION: R0	DATE: 15.06.2018

PROJECT : MUMBAI - AHMEDABAD HIGH SPEED RAIL PROJECT

OWNER :

NHSRCL, Asia Bhawan, 2nd Floor, Sector 9, Dwarka, Delhi - 110077

CONSULTANT :

RITES Bhawan, Plot No.1, Sector 29, Gurugram - 122001

ARCHITECTS :

DESIGN WORKSHOP  
100B - C Block, Kalkaji, New Delhi - 110019

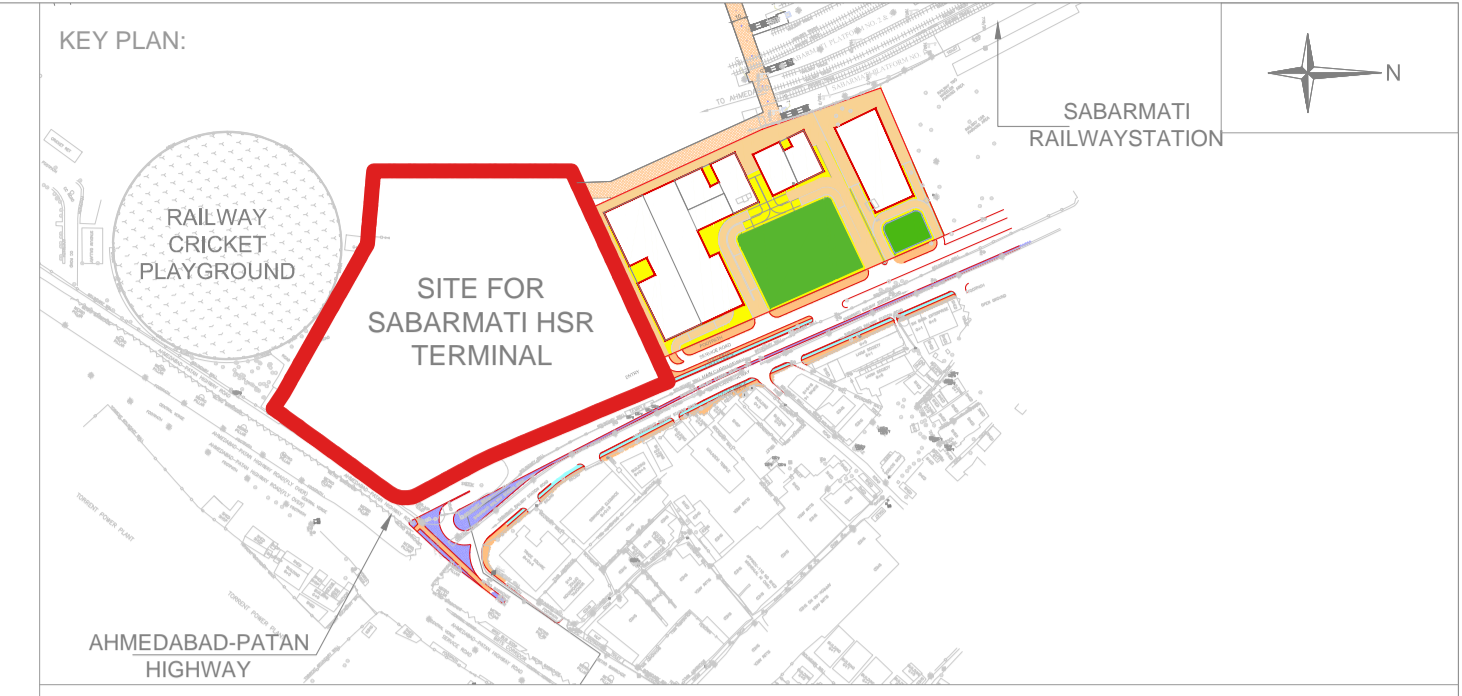
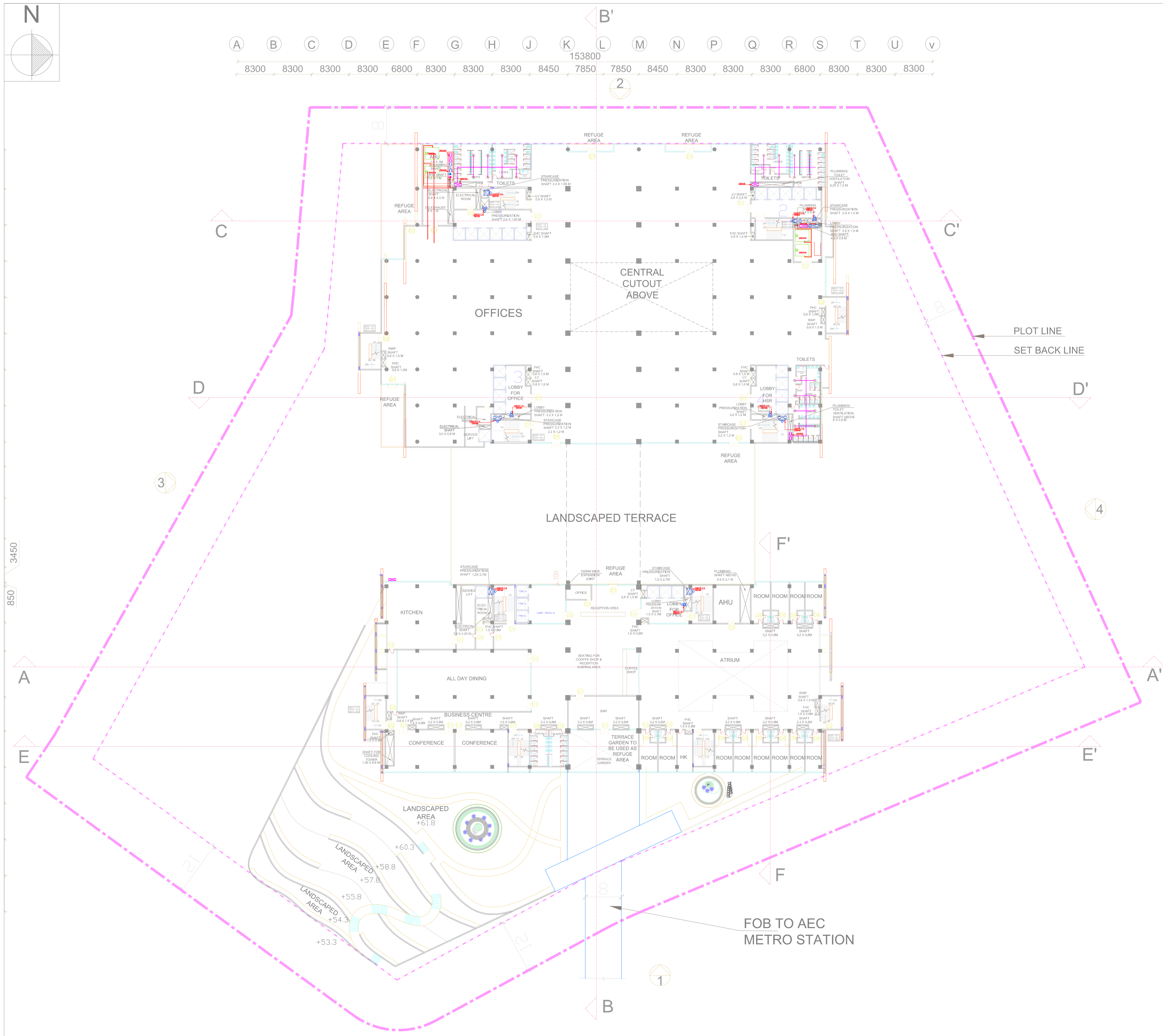

- NOTES:**
1. ALL DIMENSIONS AND LEVELS ARE IN M., UNLESS OTHERWISE MENTIONED.
  2. DRAWING SHALL NOT BE SCALED; ONLY WRITTEN DIMENSIONS SHALL BE FOLLOWED.
  3. NO WORK SHALL START WITHOUT APPROVED GOOD-FOR-CONSTRUCTION DRAWING.
  4. THIS IS THE CONCEPTUAL DRAWING AND DETAILED ENGINEERING DESIGN SHALL BE THE RESPONSIBILITY OF EXECUTING/ IMPLEMENTING AGENCIES.
  5. ACQUISITION OF LAND FOR IMPLEMENTATION OF PROJECT SHALL BE THE RESPONSIBILITY OF EXECUTING/ IMPLEMENTING AGENCIES.
  6. ALL REQUIRED STATUTORY CLEARANCES ARE TO BE OBTAINED BY THE EXECUTING/ IMPLEMENTING AGENCIES.
  7. THE NECESSARY PERMISSION FOR CUTTING OF TREES SHALL BE OBTAINED BY THE EXECUTING/ IMPLEMENTING AGENCIES FROM CONCERNED DEPT. AS PER THE EXISTING POLICY.

**REMARKS:**

LEGEND		
S.NO	SYMBOL	DESCRIPTION
1.		SUPPLY AIR DIFF.
2.		RETURN AIR DIFF.
3.		SUPPLY AIR DUCT
4.		FRESH AIR SUPPLY DUCT
5.		EXHAUST AIR RETURN DUCT
6.		CHILLED WATER SUPPLY
7.		CHILLED WATER SUPPLY
8.		CONDENSER WATER SUPPLY
9.		CONDENSER WATER RETURN
10.		MOTORIZED DAMPER

STAGE II SUBMISSION

APPROVED BY:		NHSRCL			
SIGNATURE: (Chief Architect)	DATE:	SIGNATURE: (ED/Planning)	DATE:		
PREPARED BY: RITES LTD.					
SIGNATURE: (ARCHITECT)	DATE:	SIGNATURE: (MGR/CIVIL)	DATE:	SIGNATURE: (GM/ CIVIL)	DATE:
TITLE:					

**SABARMATI HSR TERMINAL**

DWG TITLE:	FOURTH FLOOR HVAC LAYOUT
DWG NO:	HSR/SABARMATI/HVAC-07
SCALE:	1:350
REVISION: R0	DATE: 15.06.2018

PROJECT: MUMBAI - AHMEDABAD HIGH SPEED RAIL PROJECT

OWNER: NHSRCL, Asia Bhawan, 2nd Floor, Sector 9, Dwarka, Delhi - 110077

CONSULTANT: RITES Bhawan, Plot No.1, Sector 29, Gurugram - 122001

ARCHITECTS: DESIGN WORKSHOP, 100B - C Block, Kalkaji, New Delhi - 110019

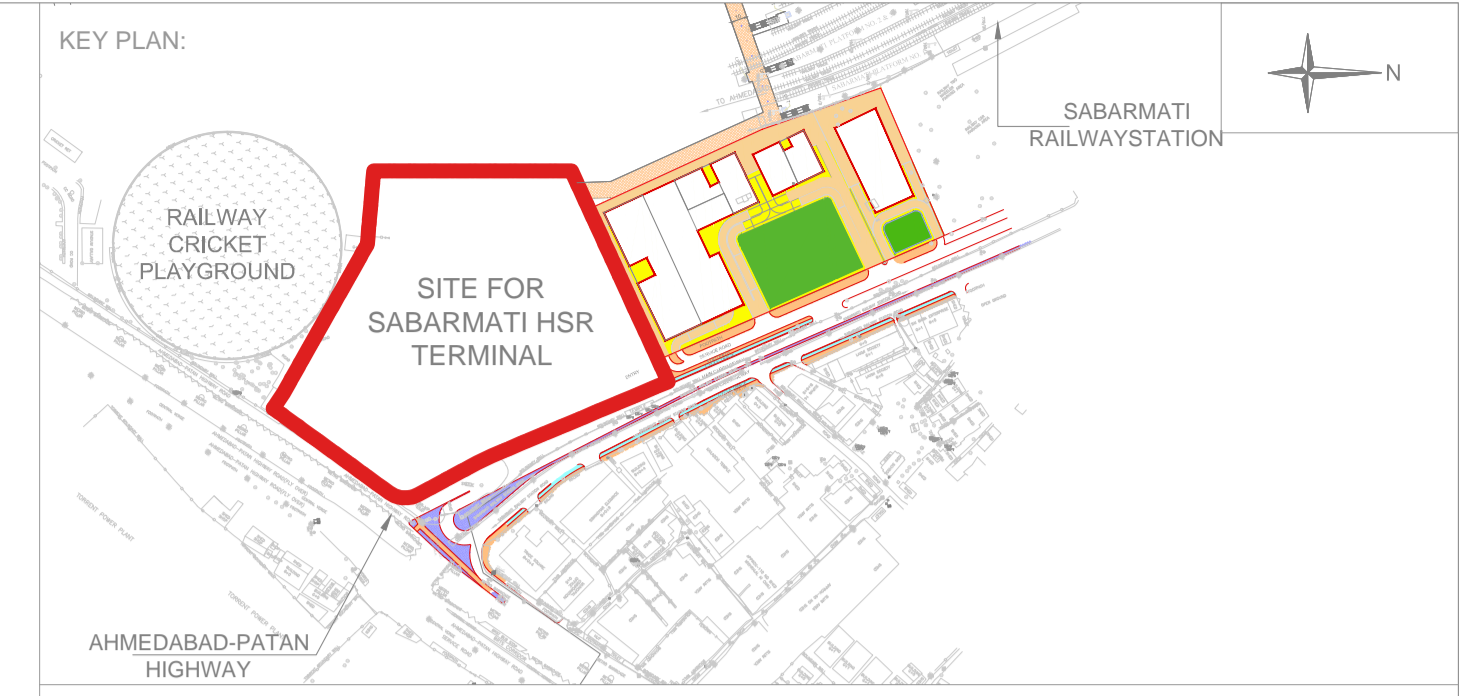
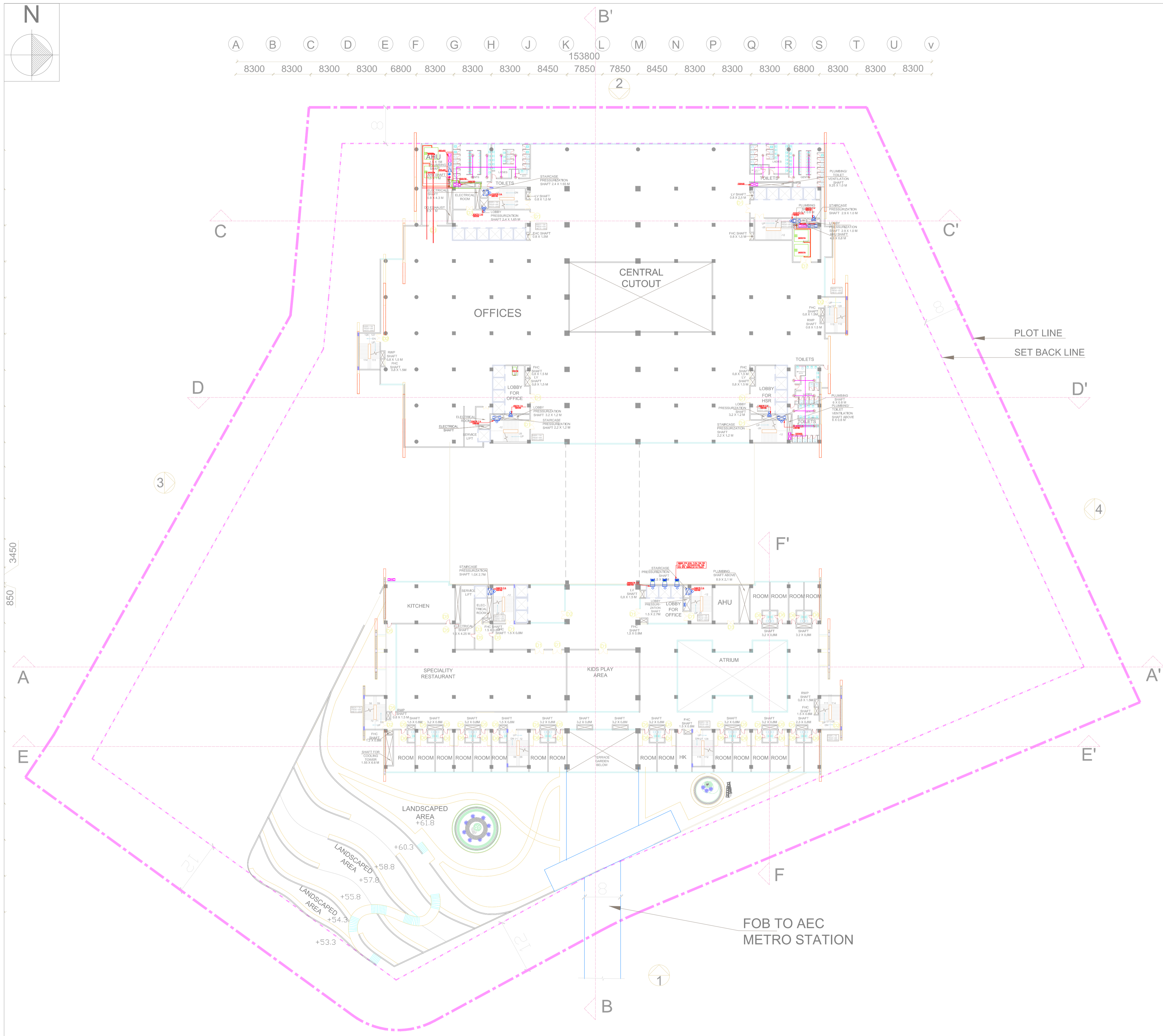

- NOTES:**
1. ALL DIMENSIONS AND LEVELS ARE IN M., UNLESS OTHERWISE MENTIONED.
  2. DRAWING SHALL NOT BE SCALED; ONLY WRITTEN DIMENSIONS SHALL BE FOLLOWED.
  3. NO WORK SHALL START WITHOUT APPROVED GOOD-FOR-CONSTRUCTION DRAWING.
  4. THIS IS THE CONCEPTUAL DRAWING AND DETAILED ENGINEERING DESIGN SHALL BE THE RESPONSIBILITY OF EXECUTING/ IMPLEMENTING AGENCIES.
  5. ACQUISITION OF LAND FOR IMPLEMENTATION OF PROJECT SHALL BE THE RESPONSIBILITY OF EXECUTING/ IMPLEMENTING AGENCIES.
  6. ALL REQUIRED STATUTORY CLEARANCES ARE TO BE OBTAINED BY THE EXECUTING/ IMPLEMENTING AGENCIES.
  7. THE NECESSARY PERMISSION FOR CUTTING OF TREES SHALL BE OBTAINED BY THE EXECUTING/ IMPLEMENTING AGENCIES FROM CONCERNED DEPT. AS PER THE EXISTING POLICY.

**REMARKS:**

LEGEND		
S.NO	SYMBOL	DESCRIPTION
1.		SUPPLY AIR DIFF.
2.		RETURN AIR DIFF.
3.		SUPPLY AIR DUCT
4.		FRESH AIR SUPPLY DUCT
5.		EXHAUST AIR RETURN DUCT
6.		CHILLED WATER SUPPLY
7.		CHILLED WATER SUPPLY
8.		CONDENSER WATER SUPPLY
9.		CONDENSER WATER RETURN
10.		MOTORIZED DAMPER

STAGE II SUBMISSION

APPROVED BY: NHSRCL

SIGNATURE: (Chief Architect) \_\_\_\_\_ DATE: \_\_\_\_\_ SIGNATURE: (ED/Planning) \_\_\_\_\_ DATE: \_\_\_\_\_

PREPARED BY: RITES LTD.

SIGNATURE: (ARCHITECT) \_\_\_\_\_ DATE: \_\_\_\_\_ SIGNATURE: (MGR/CIVIL) \_\_\_\_\_ DATE: \_\_\_\_\_ SIGNATURE: (GM/ CIVIL) \_\_\_\_\_ DATE: \_\_\_\_\_

TITLE: \_\_\_\_\_

**SABARMATI HSR TERMINAL**

DWG TITLE: **FIFTH FLOOR HVAC LAYOUT**

DWG NO: HSR/SABARMATI/HVAC-08

SCALE: **1:350**

REVISION: R0

DATE: 15.06.2018

PROJECT: **MUMBAI - AHMEDABAD HIGH SPEED RAIL PROJECT**

OWNER:

NHSRCL, Asia Bhawan, 2nd Floor, Sector 9, Dwarka, Delhi - 110077

CONSULTANT:

RITES Bhawan, Plot No.1, Sector 29, Gurugram - 122001

ARCHITECTS:

DESIGN WORKSHOP  
100B - C Block, Kalkaji, New Delhi - 110019



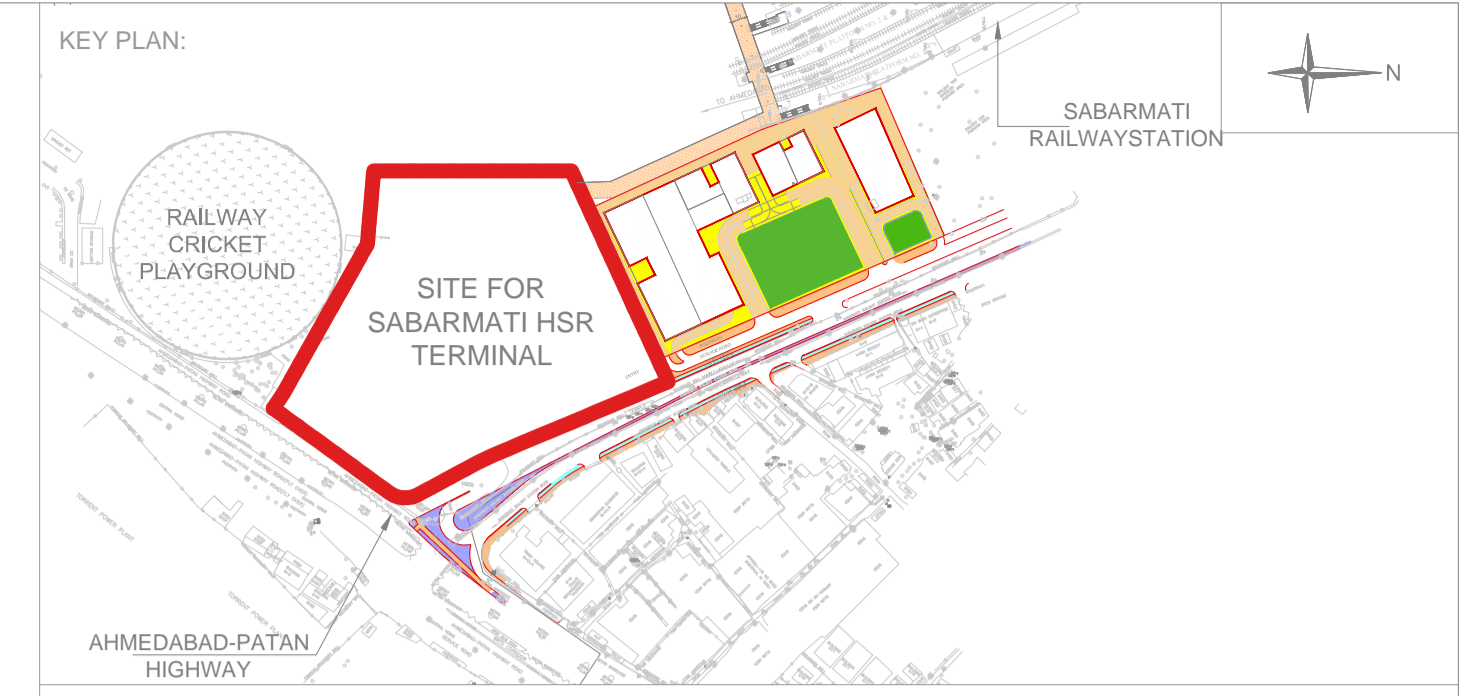
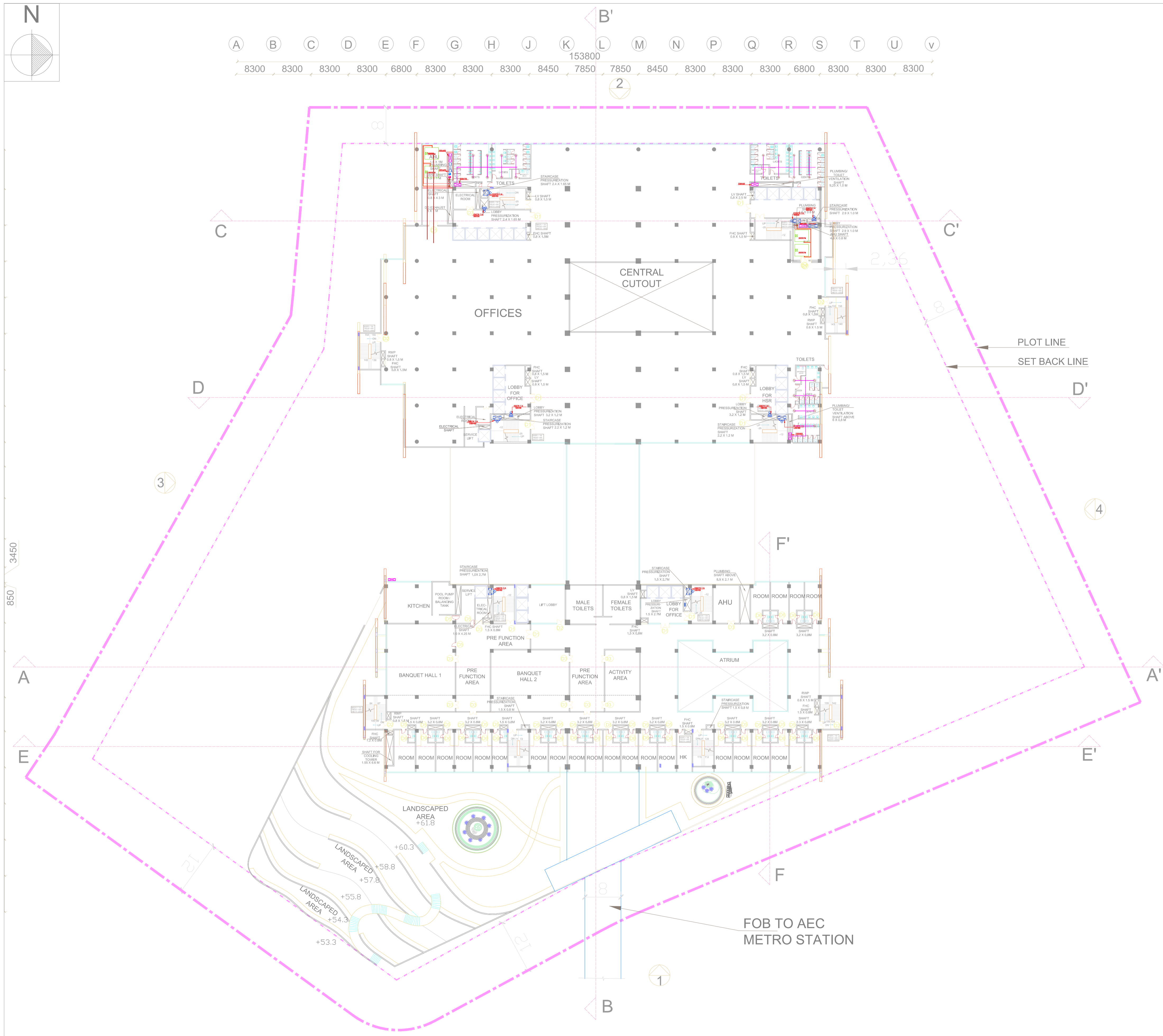

- NOTES:**
1. ALL DIMENSIONS AND LEVELS ARE IN M., UNLESS OTHERWISE MENTIONED.
  2. DRAWING SHALL NOT BE SCALED; ONLY WRITTEN DIMENSIONS SHALL BE FOLLOWED.
  3. NO WORK SHALL START WITHOUT APPROVED GOOD-FOR-CONSTRUCTION DRAWING.
  4. THIS IS THE CONCEPTUAL DRAWING AND DETAILED ENGINEERING DESIGN SHALL BE THE RESPONSIBILITY OF EXECUTING/ IMPLEMENTING AGENCIES.
  5. ACQUISITION OF LAND FOR IMPLEMENTATION OF PROJECT SHALL BE THE RESPONSIBILITY OF EXECUTING/ IMPLEMENTING AGENCIES.
  6. ALL REQUIRED STATUTORY CLEARANCES ARE TO BE OBTAINED BY THE EXECUTING/ IMPLEMENTING AGENCIES.
  7. THE NECESSARY PERMISSION FOR CUTTING OF TREES SHALL BE OBTAINED BY THE EXECUTING/ IMPLEMENTING AGENCIES FROM CONCERNED DEPT. AS PER THE EXISTING POLICY.

**REMARKS:**

LEGEND		
S.NO	SYMBOL	DESCRIPTION
1.		SUPPLY AIR DIFF.
2.		RETURN AIR DIFF.
3.		SUPPLY AIR DUCT
4.		FRESH AIR SUPPLY DUCT
5.		EXHAUST AIR RETURN DUCT
6.		CHILLED WATER SUPPLY
7.		CHILLED WATER SUPPLY
8.		CONDENSER WATER SUPPLY
9.		CONDENSER WATER RETURN
10.		MOTORIZED DAMPER

STAGE II SUBMISSION

APPROVED BY:		NHSRCL	
SIGNATURE: (Chief Architect)	DATE:	SIGNATURE: (ED/Planning)	DATE:
PREPARED BY: RITES LTD.			
SIGNATURE: (ARCHITECT)	DATE:	SIGNATURE: (MGR/CIVIL)	DATE:
SIGNATURE: (GM/ CIVIL)	DATE:	SIGNATURE: (GM/ CIVIL)	DATE:
TITLE:			

**SABARMATI HSR TERMINAL**

DWG TITLE:	SIXTH FLOOR HVAC LAYOUT
DWG NO:	HSR/SABARMATI/HVAC-09
SCALE:	1:350
REVISION: R0	DATE: 15.06.2018

PROJECT: MUMBAI - AHMEDABAD HIGH SPEED RAIL PROJECT

OWNER: NHSRCL, Asia Bhawan, 2nd Floor, Sector 9, Dwarka, Delhi - 110077

CONSULTANT: RITES Bhawan, Plot No.1, Sector 29, Gurugram - 122001

ARCHITECTS: DESIGN WORKSHOP, 100B - C Block, Kalkaji, New Delhi - 110019

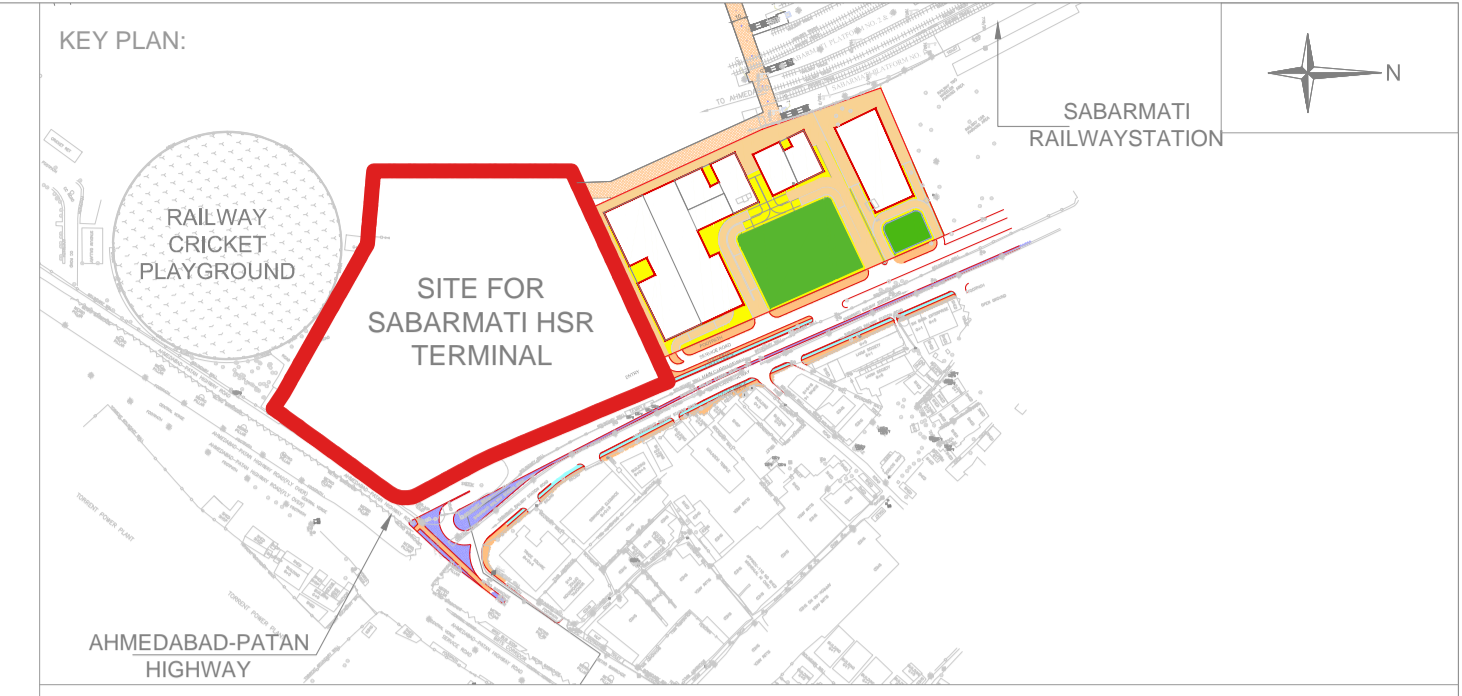
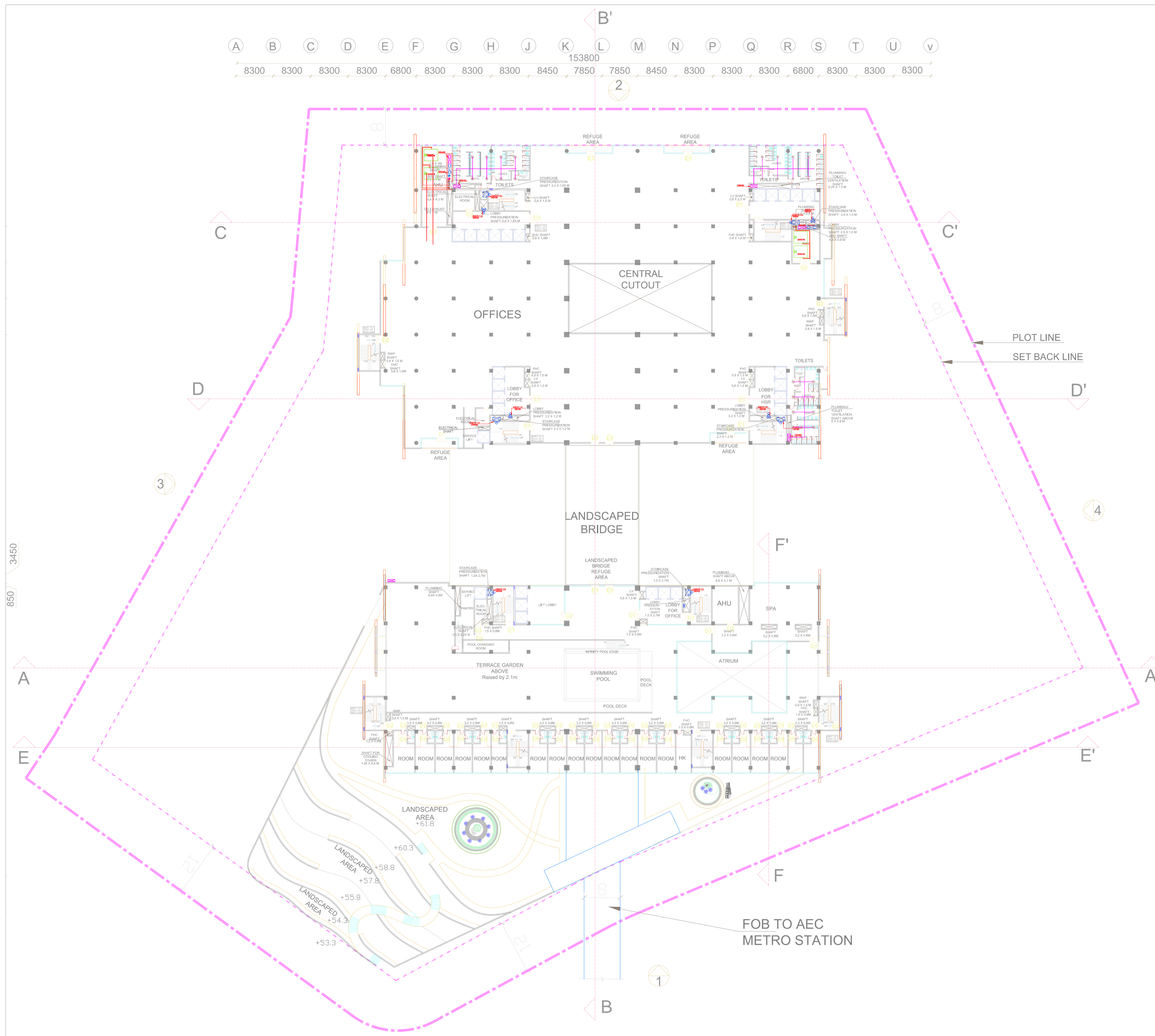

- NOTES:**
1. ALL DIMENSIONS AND LEVELS ARE IN M., UNLESS OTHERWISE MENTIONED.
  2. DRAWING SHALL NOT BE SCALED; ONLY WRITTEN DIMENSIONS SHALL BE FOLLOWED.
  3. NO WORK SHALL START WITHOUT APPROVED GOOD-FOR-CONSTRUCTION DRAWING.
  4. THIS IS THE CONCEPTUAL DRAWING AND DETAILED ENGINEERING DESIGN SHALL BE THE RESPONSIBILITY OF EXECUTING/ IMPLEMENTING AGENCIES.
  5. ACQUISITION OF LAND FOR IMPLEMENTATION OF PROJECT SHALL BE THE RESPONSIBILITY OF EXECUTING/ IMPLEMENTING AGENCIES.
  6. ALL REQUIRED STATUTORY CLEARANCES ARE TO BE OBTAINED BY THE EXECUTING/ IMPLEMENTING AGENCIES.
  7. THE NECESSARY PERMISSION FOR CUTTING OF TREES SHALL BE OBTAINED BY THE EXECUTING/ IMPLEMENTING AGENCIES FROM CONCERNED DEPT. AS PER THE EXISTING POLICY.

**REMARKS:**

LEGEND		
S.NO	SYMBOL	DESCRIPTION
1.		SUPPLY AIR DIFF.
2.		RETURN AIR DIFF.
3.		SUPPLY AIR DUCT
4.		FRESH AIR SUPPLY DUCT
5.		EXHAUST AIR RETURN DUCT
6.		CHILLED WATER SUPPLY
7.		CHILLED WATER SUPPLY
8.		CONDENSER WATER SUPPLY
9.		CONDENSER WATER RETURN
10.		MOTORIZED DAMPER

STAGE II SUBMISSION

APPROVED BY:		NHSRCL	
SIGNATURE: (Chief Architect)	DATE:	SIGNATURE: (ED/Planning)	DATE:
PREPARED BY: RITES LTD.			
SIGNATURE: (ARCHITECT)	DATE:	SIGNATURE: (MGR/CIVIL)	DATE:
SIGNATURE: (GM/ CIVIL)	DATE:	SIGNATURE: (GM/ CIVIL)	DATE:
TITLE:			

**SABARMATI HSR TERMINAL**

DWG TITLE:	SEVENTH FLOOR HVAC LAYOUT
DWG NO:	HSR/SABARMATI/HVAC-10
SCALE:	1:350
REVISION: R0	DATE: 15.06.2018

PROJECT: MUMBAI - AHMEDABAD HIGH SPEED RAIL PROJECT

OWNER: NHSRCL, Asia Bhawan, 2nd Floor, Sector 9, Dwarka, Delhi - 110077

CONSULTANT: RITES Bhawan, Plot No.1, Sector 29, Gurugram - 122001

ARCHITECTS: DESIGN WORKSHOP, 100B - C Block, Kalkaji, New Delhi - 110019

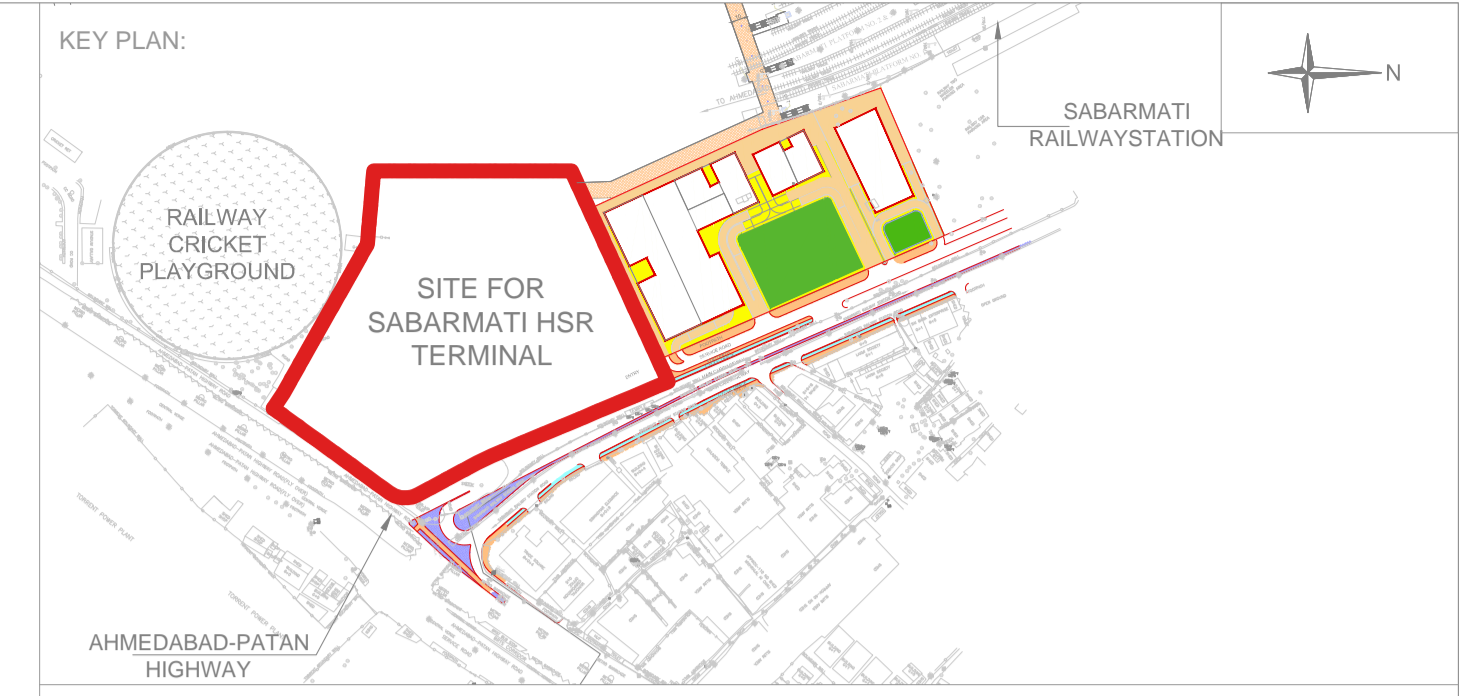
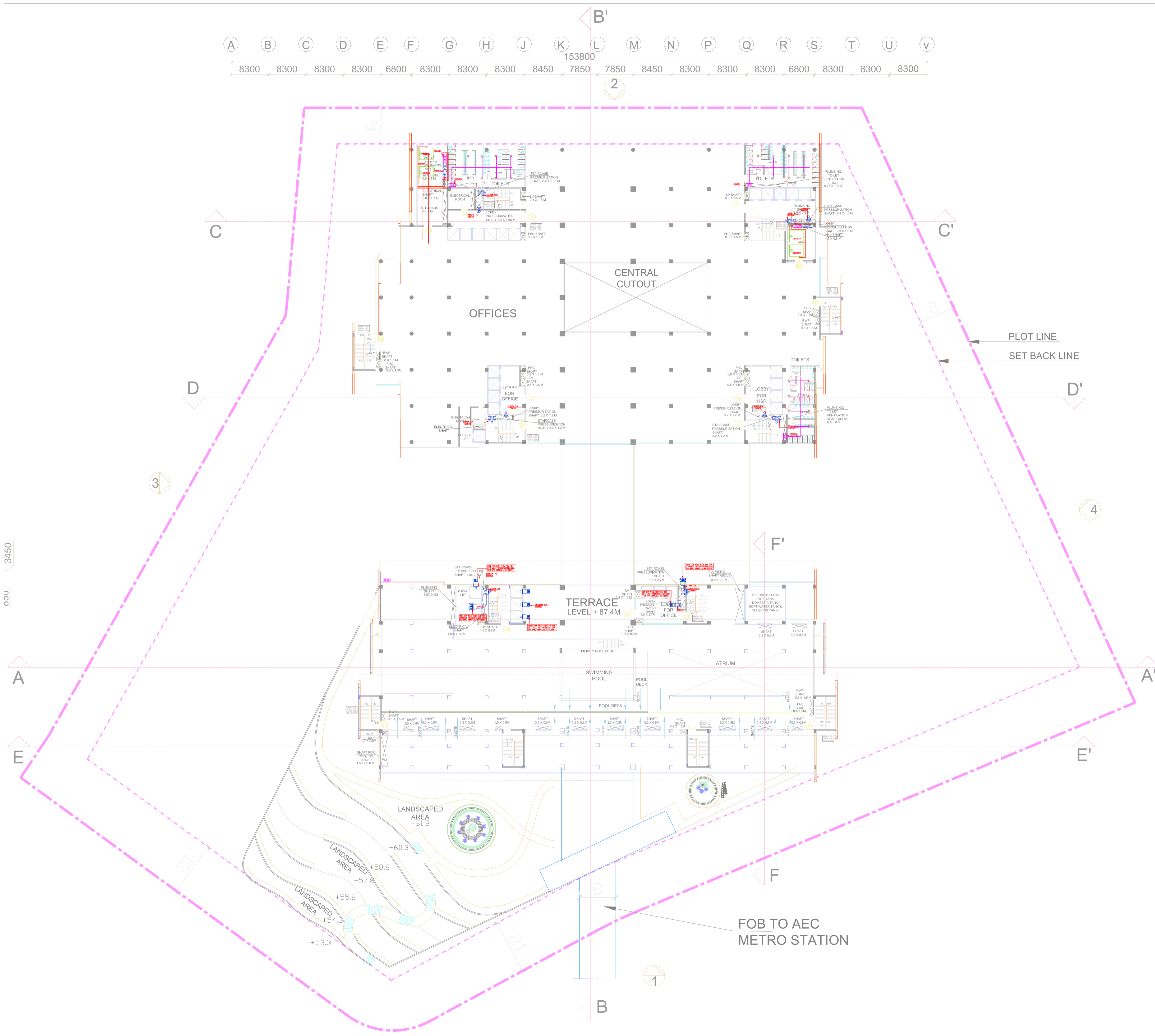

- NOTES:**
1. ALL DIMENSIONS AND LEVELS ARE IN M., UNLESS OTHERWISE MENTIONED.
  2. DRAWING SHALL NOT BE SCALED; ONLY WRITTEN DIMENSIONS SHALL BE FOLLOWED.
  3. NO WORK SHALL START WITHOUT APPROVED GOOD-FOR-CONSTRUCTION DRAWING.
  4. THIS IS THE CONCEPTUAL DRAWING AND DETAILED ENGINEERING DESIGN SHALL BE THE RESPONSIBILITY OF EXECUTING/ IMPLEMENTING AGENCIES.
  5. ACQUISITION OF LAND FOR IMPLEMENTATION OF PROJECT SHALL BE THE RESPONSIBILITY OF EXECUTING/ IMPLEMENTING AGENCIES.
  6. ALL REQUIRED STATUTORY CLEARANCES ARE TO BE OBTAINED BY THE EXECUTING/ IMPLEMENTING AGENCIES.
  7. THE NECESSARY PERMISSION FOR CUTTING OF TREES SHALL BE OBTAINED BY THE EXECUTING/ IMPLEMENTING AGENCIES FROM CONCERNED DEPT. AS PER THE EXISTING POLICY.

**REMARKS:**

LEGEND		
S.NO	SYMBOL	DESCRIPTION
1.		SUPPLY AIR DIFF.
2.		RETURN AIR DIFF.
3.		SUPPLY AIR DUCT
4.		FRESH AIR SUPPLY DUCT
5.		EXHAUST AIR RETURN DUCT
6.		CHILLED WATER SUPPLY
7.		CHILLED WATER SUPPLY
8.		CONDENSER WATER SUPPLY
9.		CONDENSER WATER RETURN
10.		MOTORIZED DAMPER

STAGE II SUBMISSION

APPROVED BY:		NHSRCL	
SIGNATURE: (Chief Architect)	DATE:	SIGNATURE: (ED/Planning)	DATE:
PREPARED BY: RITES LTD.			
SIGNATURE: (ARCHITECT)	DATE:	SIGNATURE: (MGR/CIVIL)	DATE:
SIGNATURE: (GM/ CIVIL)	DATE:	SIGNATURE: (GM/ CIVIL)	DATE:
TITLE:			

**SABARMATI HSR TERMINAL**

DWG TITLE:	<b>EIGHTH FLOOR HVAC LAYOUT</b>
DWG NO:	HSR/SABARMATI/HVAC-11
SCALE:	<b>1:750</b>
REVISION: R0	DATE: 15.06.2018

PROJECT: MUMBAI - AHMEDABAD HIGH SPEED RAIL PROJECT

OWNER: NHSRCL, Asia Bhawan, 2nd Floor, Sector 9, Dwarka, Delhi - 110077

CONSULTANT: RITES Bhawan, Plot No.1, Sector 29, Gurugram - 122001

ARCHITECTS: DESIGN WORKSHOP, 100B - C Block, Kalkaji, New Delhi - 110019

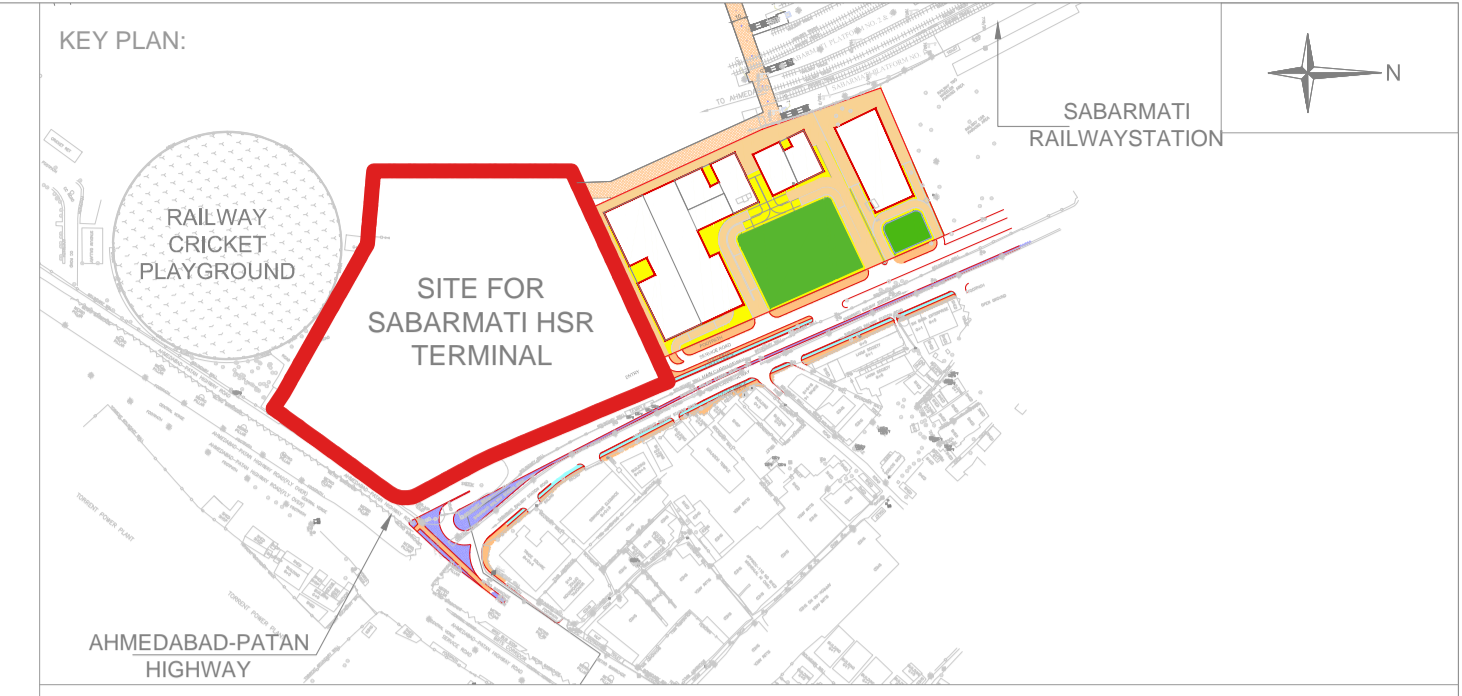
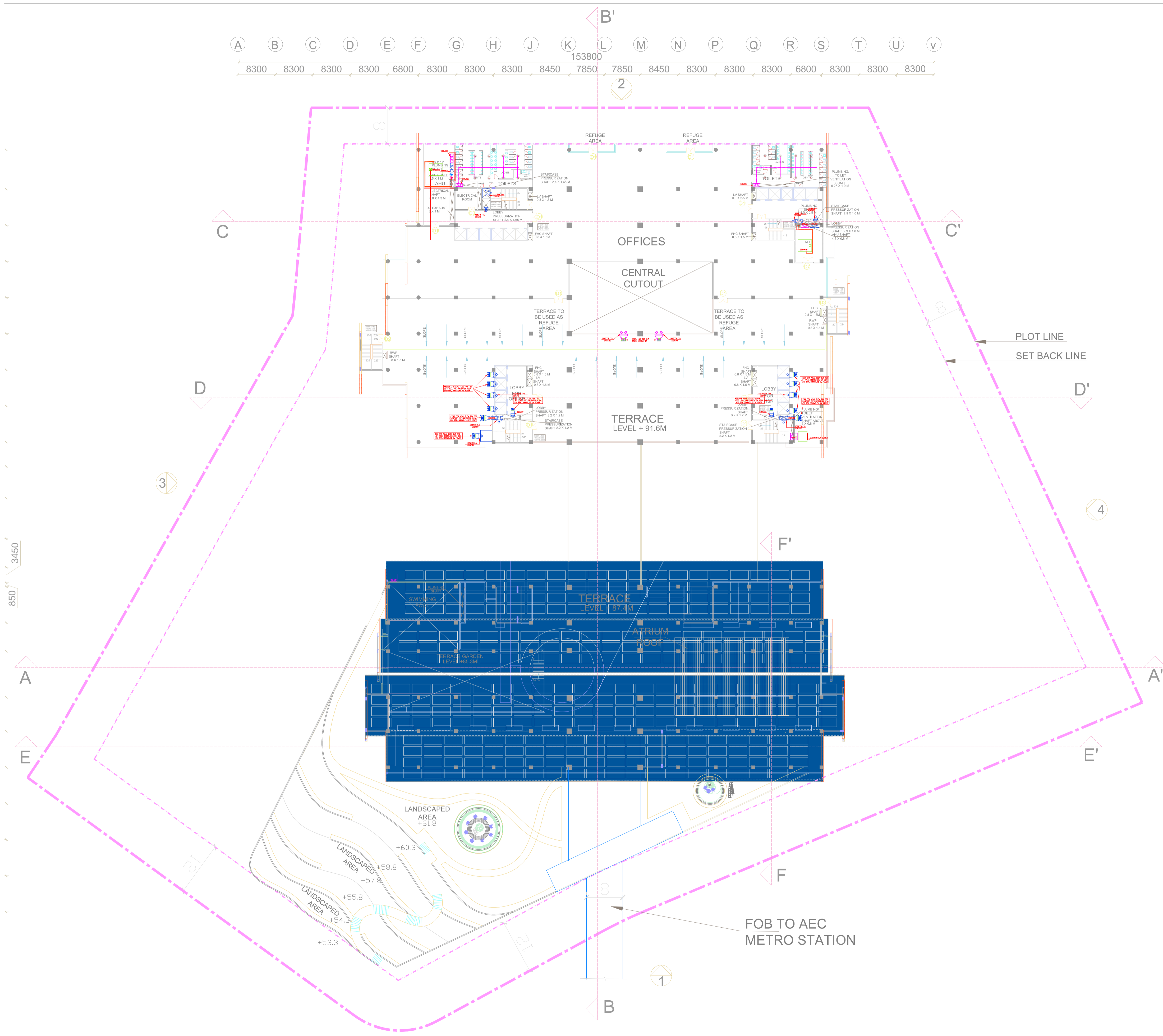

- NOTES:**
1. ALL DIMENSIONS AND LEVELS ARE IN M., UNLESS OTHERWISE MENTIONED.
  2. DRAWING SHALL NOT BE SCALED; ONLY WRITTEN DIMENSIONS SHALL BE FOLLOWED.
  3. NO WORK SHALL START WITHOUT APPROVED GOOD-FOR-CONSTRUCTION DRAWING.
  4. THIS IS THE CONCEPTUAL DRAWING AND DETAILED ENGINEERING DESIGN SHALL BE THE RESPONSIBILITY OF EXECUTING/ IMPLEMENTING AGENCIES.
  5. ACQUISITION OF LAND FOR IMPLEMENTATION OF PROJECT SHALL BE THE RESPONSIBILITY OF EXECUTING/ IMPLEMENTING AGENCIES.
  6. ALL REQUIRED STATUTORY CLEARANCES ARE TO BE OBTAINED BY THE EXECUTING/ IMPLEMENTING AGENCIES.
  7. THE NECESSARY PERMISSION FOR CUTTING OF TREES SHALL BE OBTAINED BY THE EXECUTING/ IMPLEMENTING AGENCIES FROM CONCERNED DEPT. AS PER THE EXISTING POLICY.

REMARKS:

LEGEND		
S.NO	SYMBOL	DESCRIPTION
1.		SUPPLY AIR DIFF.
2.		RETURN AIR DIFF.
3.		SUPPLY AIR DUCT
4.		FRESH AIR SUPPLY DUCT
5.		EXHAUST AIR RETURN DUCT
6.		CHILLED WATER SUPPLY
7.		CHILLED WATER SUPPLY
8.		CONDENSER WATER SUPPLY
9.		CONDENSER WATER RETURN
10.		MOTORIZED DAMPER

STAGE II SUBMISSION

APPROVED BY:		NHSRCL	
SIGNATURE: (Chief Architect)	DATE:	SIGNATURE: (ED/Planning)	DATE:
PREPARED BY: RITES LTD.			
SIGNATURE: (ARCHITECT)	DATE:	SIGNATURE: (MGR/CIVIL)	DATE:
SIGNATURE: (GM/ CIVIL)	DATE:	SIGNATURE: (GM/ CIVIL)	DATE:
TITLE:			

**SABARMATI HSR TERMINAL**

DWG TITLE:	<b>NINTH FLOOR HVAC LAYOUT</b>
DWG NO:	HSR/SABARMATI/HVAC-12
SCALE:	<b>1:750</b>
REVISION: R0	DATE: 15.06.2018

PROJECT: MUMBAI - AHMEDABAD HIGH SPEED RAIL PROJECT

OWNER:

NHSRCL, Asia Bhawan, 2nd Floor, Sector 9, Dwarka, Delhi - 110077

CONSULTANT:

RITES Bhawan, Plot No.1, Sector 29, Gurugram - 122001

ARCHITECTS:

DESIGN WORKSHOP  
100B - C Block, Kalkaji, New Delhi - 110019

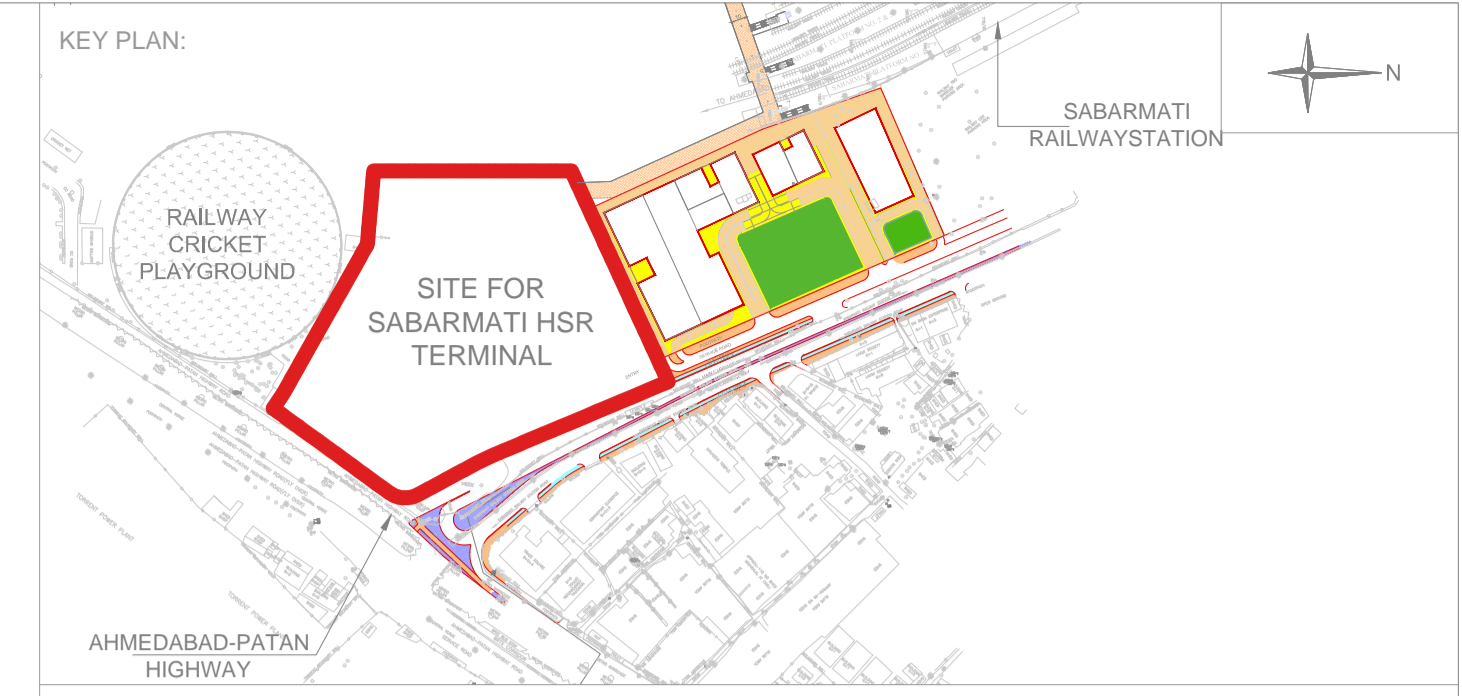
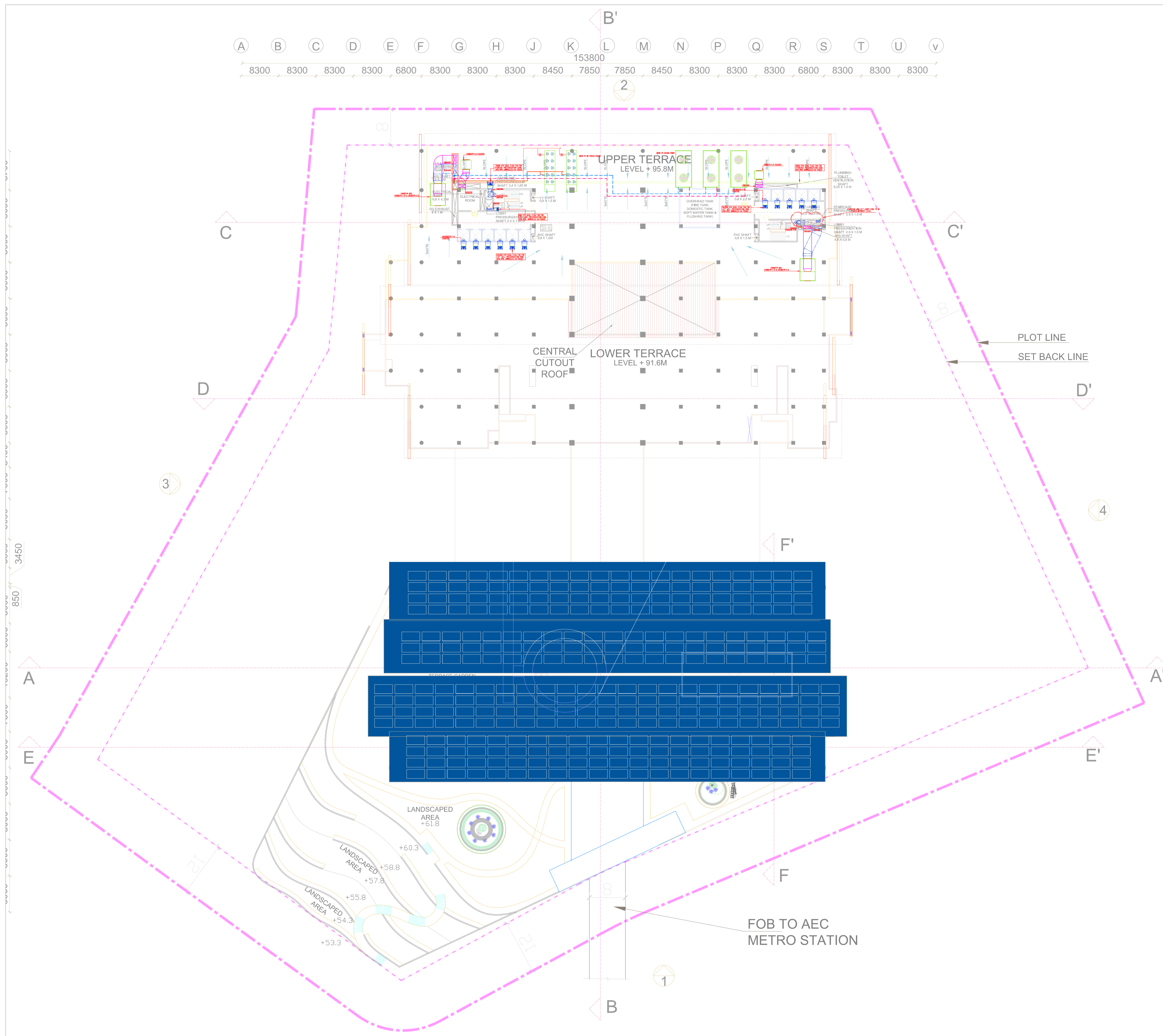

- NOTES:**
1. ALL DIMENSIONS AND LEVELS ARE IN M., UNLESS OTHERWISE MENTIONED.
  2. DRAWING SHALL NOT BE SCALED; ONLY WRITTEN DIMENSIONS SHALL BE FOLLOWED.
  3. NO WORK SHALL START WITHOUT APPROVED GOOD-FOR-CONSTRUCTION DRAWING.
  4. THIS IS THE CONCEPTUAL DRAWING AND DETAILED ENGINEERING DESIGN SHALL BE THE RESPONSIBILITY OF EXECUTING/ IMPLEMENTING AGENCIES.
  5. ACQUISITION OF LAND FOR IMPLEMENTATION OF PROJECT SHALL BE THE RESPONSIBILITY OF EXECUTING/ IMPLEMENTING AGENCIES.
  6. ALL REQUIRED STATUTORY CLEARANCES ARE TO BE OBTAINED BY THE EXECUTING/ IMPLEMENTING AGENCIES.
  7. THE NECESSARY PERMISSION FOR CUTTING OF TREES SHALL BE OBTAINED BY THE EXECUTING/ IMPLEMENTING AGENCIES FROM CONCERNED DEPT. AS PER THE EXISTING POLICY.

**REMARKS:**

LEGEND		
S.NO	SYMBOL	DESCRIPTION
1.		SUPPLY AIR DIFF.
2.		RETURN AIR DIFF.
3.		SUPPLY AIR DUCT
4.		FRESH AIR SUPPLY DUCT
5.		EXHAUST AIR RETURN DUCT
6.		CHILLED WATER SUPPLY
7.		CHILLED WATER SUPPLY
8.		CONDENSER WATER SUPPLY
9.		CONDENSER WATER RETURN
10.		MOTORIZED DAMPER

**STAGE II SUBMISSION**

APPROVED BY: NHSRCL

SIGNATURE: (Chief Architect)      DATE:      SIGNATURE: (ED/Planning)      DATE:

PREPARED BY: RITES LTD.

SIGNATURE: (ARCHITECT)      DATE:      SIGNATURE: (MGR/CIVIL)      DATE:      SIGNATURE: (GM/ CIVIL)      DATE:

TITLE: **SABARMATI HSR TERMINAL**